

**ADDENDUM NO. 1**

City of Franklin  
Engineering Office  
109 Third Avenue South  
Franklin, TN 37064

Contract No. 2023-0050  
Project Southeast Municipal Complex  
\_\_\_\_\_  
\_\_\_\_\_

Date of Issuance 09/09/2024

You are directed to make the following changes in the Contract Document:

Description:

- I) The Contract Times as specified in Article 4 – Contract Times; 4.02 Contract Times shall be revised as follows:  
4.02 Contract Times  
A. The Work shall be substantially complete within **One Thousand and Eighty (1,080)** days after the date when the Contract Times commence to run as provided in Paragraph 4.01 of the General Conditions, and finally complete within **Ninety (90)** days after Substantial Completion.
- II) The Bid opening date has been revised to allow additional time to potential bidders. The City shall receive sealed bids in the Building & Neighborhood Services (BNS) Department at Suite 110 of City Hall, 109 3<sup>rd</sup> Avenue South, Franklin, TN 37064 until **2:20 PM (CST) on Thursday, October 10, 2024.**
- III) The final date to ask questions shall be revised to **September 19<sup>th</sup>, 2024, by 5:00 PM.**
- IV) **Revised Section 002114 – Supplemental Instructions To Bidders – Sports Field Contractors Pre-Qualifications (See Attachment A)**
- V) **Questions and Clarifications:**

Q1	Spec section 002114.1.1.C says to list Sports Field Contractors (SFC) on the Bid Form. The Bid Form does not have a place for listing these contractors. Do we list the name of the SFC contractor on the outside of the Bid envelope instead?
A1	<b>Answer: Yes, the SPC contractor shall be written on the outside of the bid envelope and on the bottom of page 2 of Exhibit A – BID FORM.</b>

Q2	Please confirm the Sports Field Lighting foundations, pole, and installation will be by Owner's Vendor and not a part of this contract
A2	<b>Answer: Sports Field Lighting is specified as an Owner Furnished &amp; Owner-Installed Product. Refer to Specification Section 0164-00 Owner Furnished Materials – Section 2.2.A.1 &amp; 2.2.A.2.c.2 for detailed description of OFOI Products and responsibilities of Contractor and Owner's Vendor.</b>

Q3	L1.00 Detail 1 Note #3; Please clarify who is to provide the buffer signpost.
A3	<b><u>Answer:</u> The contractor is to provide the post type specified in Note 3.</b>

Q4	Site Utility plans shows proposed gas runs. Clarify if the utility provider will install the site service lines and contractor is to coordinate or if contractor is to install the gas lines as shown starting at the tie-in point.
A4	<b><u>Answer:</u> The contractor is responsible for performing the gas line work for this project and shall be an approved Atmos Energy contractor and is required to follow &amp; adhere to all Atmos Energy &amp; City of Franklin procedures &amp; guidelines.</b>

Q5	Detail 6/C4.3B Are the 4" dia fixed bollards just to be located at the gate; or is it the intention to use these similar bollards at the buildings
A5	<b><u>Answer:</u> The intent is to use two styles of bollards, fixed and removable, throughout the project. Depending on the location it will be the removable or fixed bollard as shown on sheet C4.3B. See notes on plan sheets.</b>

Q6	ES-1.02 Keynote 16 calls for HySecurity's Strong Arm barrier, but the Civil Drawings and Specifications call for a slide gate. Will there be both a Slide Gate as well as a barrier arm?
A6	<b><u>Answer:</u> No, just the motorized slide gate with HID card access.</b>

Q7	Confirm all items on the site furnishings schedule in detail 6 of L7.04 are contractor furnished and contractor installed.
A7	<b><u>Answer:</u> Yes, all items on the site furnishings schedule in detail 6 of drawing L7.04 are contractor furnished and contractor installed.</b>

Q8	Atmos recommends the gas service to the buildings should be 2" HDPE rather than the 1" PE that is shown. Please confirm the 2" HDPE is required for this project.
A8	<b><u>Answer:</u> Yes, use 2" HDPE for the gas service to the buildings per Atmos' recommendation.</b>

Q9	For the rootzone mixture, Appendix C states it to be a 4" layer, however the plans show 6". Please advise which is to be correct.
A9	<b>Answer: For the purpose of this question "rootzone" and the phrase "sand amended topsoil" are the same thing. The rootzone is to be 6" as depicted in Natural Turf Drainage Details 2 &amp; 5 on Drawing L7.02.</b>

Q10	Detail 5 on L7.02 show laying the hydraway lines on top of fabric, installing 5" of #78s and wrapping the fabric around the rock and overlapping on top, leaving 30" of rock each way from centerline of pipe. Would it be acceptable if we were to lay fabric over the entirety of the field, Installed the Hydraway Drains per plan, then spread the 5" of #78s over the entirety of the field and capped with another layer of fabric prior to placing the rootzone mixture?
A10	<b>Answer: This would be an acceptable solution and would require 5" of #78s over the entirety of the field and overlapped at the ends and seams a minimum of 18" (typ).</b>

Q11	The contours are all marked with elevation 0 in the CADD file provided. Please provide an updated file that has elevations built into the contour lines.
A11	<b>Answer: Updated CAD files have been included. Click <a href="#">HERE</a> to access updated CAD information.</b>

**VI) NOTE: At least one more addendum with additional questions / answers will be issued**

**VII) Attachments:**

- a) Attachment A – Revised Section 002114 – Supplemental Instructions To Bidders – Sports Field Contractors Pre-Qualifications
- b) Attachment B – Revised 016400 – Owner Furnished Materials.
- c) Attachment C – Southeast Municipal Complex Prebid Meeting Minutes.

**END of Addendum**

---

SECTION 002114 - SUPPLEMENTAL INSTRUCTIONS TO BIDDERS – SPORTS FIELD CONTRACTORS PRE-QUALIFICATIONS

PART 1 - GENERAL

1.1 SUMMARY

- A. Pre-Qualification of Sports Field Contractors (SFC) will be at the discretion of the Owner based on the information submitted and interviews of owners of previous projects completed by the SFC, financial stability, and equipment available to accomplish the task, experience of labor force and any other pertinent information the Owner requires to determine pre-qualified sports field contractors.
- B. Required scope of work by the SFC on this project shall include grading of subgrade to one-half inch of specified elevations, installation of underground drainage system, installation of underground irrigation systems, sifting topsoil on site and blending it with 50% sand for the 4" sand cap on the sports fields, soil amendments, finish grading of the sports fields using laser grading technology to one-quarter inch of specified elevations, and sodding and grow-in of the fields. A pre-qualified SFC must perform this work with their own forces. Irrigation installation and grow-in can be subcontracted but must be performed under the supervision of the SFC.
- C. The Owner is pre-qualifying SFC's in order to identify the pre-qualified firms in bid documents for the Project. General Contractors bidding on the project must use one of the pre-qualified SFC's listed in the bid documents. Bidders shall identify the SFC they will use in their bid on the Bid Form. Failure to identify a pre-qualified SFC may result in the bid being deemed non-responsive and therefore rejected.

1.2 PRE-QUALIFIED SPORTS FIELD CONTRACTORS

- A. The following Sports Field Contractors have been deemed pre-qualified for this Project:
  - 1. Carolina Green Corporation  
Contact: Chad Price  
Phone: 704-753-1707  
Email: cprice@cgfields.com  
10108 Indian Trail-Fairview Rd.  
Indian Trail, NC 28079
  - 4. Precision Turf LLC  
Contact: Jonathan Holland  
Phone: 770-921-1925  
Email: jonathan@ptuff.com  
3276 Buford Dr., Ste 104 #351  
Buford, GA 30519

- |   |   |
|---|---|
| <p>2. Sports Turf Company, Inc.<br/>Contact: Todd Wiggins<br/>Phone: 770-832-8691<br/>Email: <a href="mailto:twiggins@sportsturf.net">twiggins@sportsturf.net</a><br/>1487 Black Dirt Rd.<br/>Whitesburg, GA 30185</p>            | <p>5. River Region Sports Fields<br/>Contact: Jon Mitchell<br/>Phone: 205-617-4884<br/>Email: <a href="mailto:jon@riverregionsportsfields.com">jon@riverregionsportsfields.com</a><br/>P. O. Box 1524<br/>Millbrook, AL 36054</p>         |
| <p>3. Gameday Athletic Surfaces<br/>Contact: Daniel Ruggiero<br/>Phone: 205-547-0628<br/>Email:<br/><a href="mailto:daniel@gamedayathleticsurfaces.com">daniel@gamedayathleticsurfaces.com</a></p>                                | <p>6. SportsTurf Solutions, LLC<br/>Contact: Ryan Moriarity<br/>Phone: 615-566-9799<br/>Email: <a href="mailto:ryan@sportsturfconstruction.com">ryan@sportsturfconstruction.com</a><br/>606 St. Blaise Road<br/>Gallatin, TN 37066</p>    |
| <p>7. Athletic Fields, Inc.<br/>Contact: Josh Morrow<br/>Email: <a href="mailto:jmorrow@athleticfields.org">jmorrow@athleticfields.org</a><br/>Phone: 770-281-1728<br/>54 Brown Farm Road SW<br/>Cartersville, GA 30120</p>       | <p>8. Byrne &amp; Jones Construction<br/>Contact: Kenneth Garrett<br/>Phone: 615-762-0248<br/>Email: <a href="mailto:kgarrett@byrneandjones.com">kgarrett@byrneandjones.com</a><br/>13940 St. Charles Rock Rd<br/>St. Louis, MO 63044</p> |
| <p>9. Baseline Sports Construction<br/>Contact: Steve Clift<br/>Email: <a href="mailto:steve@baselinellc.com">steve@baselinellc.com</a><br/>Phone: 800- 205-9521<br/>3600 Henson Road<br/>Knoxville, TN 37921</p>                 | <p>10. Athletic Construction, Inc.<br/>Contact: Tony Strickland<br/>Email: <a href="mailto:tony@athleticconstruction.com">tony@athleticconstruction.com</a><br/>Phone: 770- 532-7337<br/>3744 Turkwood Drive<br/>Oakwood, GA 30586</p>    |
| <p>11. Warner's Athletic Construction Co.<br/>Contact: Lou Warner<br/>Phone: 615-430-6664<br/>Email: <a href="mailto:Lou@warnerathletic.com">Lou@warnerathletic.com</a><br/>570 Huntley Industrial Blvd.<br/>Smyrna, TN 37167</p> | <p>12. Fields, Inc.<br/>Phone: 678-710-8585<br/>3760 Sixes Road<br/>Canton, GA 30114</p>  |

### 1.3 REQUESTS FOR PRE-QUALIFICATION

- A. Sports Field Contractors which are not identified above may submit request for consideration as a Pre-Qualified Sports Field Contractor in accordance with the following provisions.
- B. Only SFC's meeting all of the following minimum qualifications will be considered:
1. The SFC shall demonstrate that they have experience with multiple projects similar in scope to this project that have been completed within the last three consecutive years. This project includes four natural turf multi-purpose sports fields. Said project(s) shall be of similar scope and character with the work to be performed

- and have been performed by and only by the actual SFC that is submitting their qualifications. Further, prior work performed as a subcontractor involving only part of direct field construction on such previous projects shall not be considered. For example, contractors whose primary experience only involves the installation of sod on athletic fields shall not be considered as SFC's.
2. The SFC must have experience with the installation of natural turf multi-purpose sports fields. The SFC must have demonstrated experience with the installation of a minimum of 15 full size (at least 70,000 square feet) natural turf fields and that included the SFC's scope of work over the past three years.
  3. SFC should have on its staff a Certified Field Builder (CFB) certified by ASBA.
  4. The SFC shall provide an on-site construction superintendent having at least three years' experience constructing athletic fields using laser grading systems and with the installation of natural turf fields.
  5. The SFC must perform all required work with their own staff supervision and employees, using company equipment either owned or leased without the subcontracting of any of the said required work, except the SFC may be allowed to subcontract 1) irrigation, 2) grow-in maintenance (if required), as long as the SFC directly controls and supervises the subcontractor(s).
  6. SFC shall have experience with automatically controlled laser guided grading equipment, specifically a dual slope hydraulically actuated soil plane adjustable to 1/100 of a foot. Equipment shall be pulled with a high flotation tractor with a gross weight of less than 15,000 lbs. Equipment must be made available for inspection by the Owner if requested. The contractor shall also use other specialized sports field equipment such as tractors, disc harrows, power rakes, tillers, infield groomers and drags in construction of athletic fields.
  7. The SFC must demonstrate the ability to accomplish the work in accordance with the Owner's schedule as evidenced by their current and projected workload and the availability of equipment and resources to accomplish the work.
- C. The Owner may make minor exceptions to the minimum qualifications if deemed in the Owner's best interests to do so.
- D. The following information must be submitted in order to be considered as pre-qualified as an SFC:
1. A completed copy of the attached "Statement of Qualifications".
  2. The following information for each of the projects required under Item 1 and 4 in the minimum qualifications set forth above:
    - a. Project Name and Location
    - b. Project Description
    - c. Owner's Name
    - d. Owner's Complete Address
    - e. Owner's Telephone Area Code and Number
    - f. Owner's Current Contact Person
  3. A listing of laser technology and equipment plus other specialized sports field construction equipment owned and/or leased.

4. Resumes or other evidence of the experience of the principals of the firm and for the project superintendent proposed for this project.
  5. Any other information concerning the SFC that evidences your ability to meet the minimum qualifications necessary to be qualified for the project.
- E. The decision on whether an SFC is qualified rests solely with the Owner.
- F. Requests for approval of a SFC that is not already pre-qualified must be received by the A/E at the address below a minimum of 15 calendar days prior to the date of receipt of bids in order to be considered. Any request received after this date will not be considered. If an SFC submits qualifications and is deemed prequalified, all prime bidders will be notified of such by Addendum.
- G. Questions may be directed to and submittals may be mailed, emailed, faxed, or delivered to:

John Brown, ASLA  
Barge Design Solutions, Inc.  
1110 Market Street, Suite 200  
Chattanooga, TN 37402  
423.756.3025 direct  
423.774.7576 mobile  
423.756.8477 fax  
[john.brown@bargedesign.com](mailto:john.brown@bargedesign.com)

PART 2 - PRODUCTS (NOT USED)

PART 3 - EXECUTION (NOT USED)

END OF DOCUMENT 002114

STATEMENT OF QUALIFICATIONS  
SPORTS FIELD CONTRACTOR

All questions must be answered and the data given must be clear and comprehensive. This statement must be notarized. If necessary, questions may be answered on separate attached sheets. The Bidder may submit any additional information desired to demonstrate their qualifications.

1. Name of Sports Field Contractor's Company:

\_\_\_\_\_

2. Permanent main office address, phone and fax, email and (if available) web site address:

\_\_\_\_\_

\_\_\_\_\_

3. When organized:

4. If a Corporation, where incorporated:

5. How many years have you been engaged in the contracting business under your present firm or trade name?

6. Contracts on hand: (Schedule these, showing the name of the project, the Owner, amount of each contract and the appropriate anticipated dates of completion):

7. Provide the company's gross revenues for sports field construction only for the past three years (this information will remain confidential):

2019\_\_\_\_\_ 2018\_\_\_\_\_ 2017\_\_\_\_\_



8. General description of work performed by your company:

9. Have you ever failed to complete any work awarded to you? If so, where and why.

10. Have you ever defaulted on a contract? If so, where and why.

The undersigned hereby authorizes and requests any person, firm, or corporation to furnish any information requested in verification of the recitals comprising this Statement of Qualifications – SFC.

Dated at \_\_\_\_\_ this \_\_\_\_\_ day of \_\_\_\_\_, 20\_\_\_\_\_.

Sports Field Contractor:

Company Name: \_\_\_\_\_

By (Signature): \_\_\_\_\_

Printed Name: \_\_\_\_\_

Title: \_\_\_\_\_

---

SECTION 016400 – OWNER FURNISHED MATERIALS

PART 1 - GENERAL

1.1 SCOPE

- A. This Section of the Specifications identifies materials which will be or have been purchased by the Owner for use on this Project and outlines the requirements necessary to coordinate the purchase of specified materials by the Owner and defines the responsibilities of the Contractor related to the procurement, delivery, installation, and start-up of the Owner furnished materials.
- B. The Contractor shall be responsible for scheduling the delivery of the materials to the Project site, as well as establishing the hours of delivery and method of delivery to the Project site.
- C. "Seller" shall mean the party under separate contract with Owner to furnish the products or special services specified herein.
- D. The "Owner Furnished Materials Scope of Work" document identifies the materials to be furnished by the Owner. Refer to Section 012205 Measurement and Payment for additional information related to specific allocation of responsibility for various Owner furnished items.

1.2 COSTS

- A. The Contractor's receiving, unloading, storing, handling, distributing, labor, installation, and overhead costs, plus profit and other expenses contemplated for the Owner furnished materials shall be included in the base bid. The Contractor shall consider the freight cost to the Project site as being prepaid.
- B. If the terms and conditions of delivery of material and services differ from those given in these Contract Documents, then the Contractor shall include the cost of differences in the base bid.
- C. Should the delivered product from the Supplier not be in accordance with the Specifications, the Contract may be adjusted by a change order.
- D. The amount of change order will not recognize any changes in unloading, storage, handling, labor, installation, and overhead costs, nor profit and other expenses caused by the adjustment of the final invoice amount.
- E. Contractor shall pay all delivery waiting charges.

- F. Where the Contractor is responsible for ordering the proper quantities of Owner furnished materials, the Contractor shall be responsible for all restocking fees associated with the return of excess materials ordered by the Contractor. When such excess items are special order and not eligible for return, the Contractor shall reimburse the Owner for the full purchase price of such excess material.

### 1.3 SUBMITTALS

- A. The Contractor shall submit listing of Owner Furnished Materials that have been delivered with each periodic payment request as evidenced by providing copies of all bills of lading.
- B. Contractor shall submit with each construction progress schedule a schedule for required deliveries of Owner furnished material.
- C. All Seller submittals are to be provided from the Seller to the Contractor for submission to the Engineer.

### 1.4 OWNER AND CONTRACTOR RESPONSIBILITIES

- A. Owner will only be purchaser of the material identified in this Section. All coordination and ownership of responsibilities as identified by the Specifications associated with each item of material shall be by the Contractor. Shop drawing coordination and compliance with Specifications will be the Contractor's responsibility. The manufacturer's installation, operation, and maintenance instructions for Owner furnished products shall also be the Contractor's responsibility.
- B. All communication regarding scope of supply, delivery, installation, warranty repair, and manufacturer's services is to be conducted directly between the Contractor and the supplier.
- C. All parts or adapters necessary to integrate the Owner furnished products with products provided by the Contractor shall be provided by the Contractor at no additional cost to the Owner.
- D. All electrical field wiring and instrumentation installation necessary to integrate the Owner furnished material and achieve a complete and functional system shall be provided by the Contractor at no additional cost to the Owner.
- E. Contractor shall be responsible for scheduling shop drawings, the delivery of the materials to the Project site, as well as establishing the hours of delivery, and method of delivery to the Project site. Contractor shall maintain communication with the material suppliers, and the Owner as necessary, to keep informed as to shipment schedules.
- F. Should any material be damaged, lost or fail under test, and in the opinion of the Engineer, such failure or damage is the result of improper handling, it shall be replaced in kind by the Contractor at no cost to the Owner.

- G. Fittings, solid sleeves and special pipe, which are not shown on the Drawings and which are installed for the convenience of the Contractor, shall not be paid for by the Owner.
- H. Upon receipt of materials from the manufacturer, the Contractor shall make an inspection of such materials, checking and certifying the bill of lading, noting any discrepancies and obtaining a proper memorandum signed by the agent of the carrier for any shortage in the shipment, or for any damaged materials received. All bills of lading and any memorandum for shortage or damage of material in the shipment shall be promptly submitted to the Engineer. The Contractor shall be responsible for distribution of all materials as required to complete the work. Materials furnished to the Contractor shall be in the custody of the Contractor from the time of receipt by the Contractor of such materials from the carrier until final acceptance of the completed work. The Contractor shall be responsible for any loss or damage to materials furnished by the Owner.
- I. Unless indicated otherwise, products shall be furnished freight on board to the Project site.
- J. Upon delivery, the Contractor shall conduct with Owner or Engineer a joint inspection for the purpose of identifying product, general verification of quantities, and observation of apparent condition. Such inspection will not be construed as final or as receipt of any product that, as a result of subsequent inspections and tests, are determined to be nonconforming.
- K. Damaged or incomplete products to be returned for replacement shall not be unloaded, except as necessary to expedite return shipment. Contractor shall submit claims for transportation damage and expedite replacement of damaged, defective, or deficient products.
- L. Indicate signed acceptance of delivery on a copy of the bill of lading.

#### 1.5 UNLOADING, STORAGE AND PROTECTION

- A. Contractor shall have complete responsibility for unloading Owner furnished material. Unload material upon delivery to Project site. Unload material in accordance with manufacturers' instructions, or as specified.
- B. Store, protect, and maintain material to prevent damage until final acceptance of completed work. Damage to or loss of material during unloading or after unloading shall be repaired to original condition, or replaced with new identical material, at the discretion of Engineer at no additional cost to the Owner.
- C. Maintain complete inventory of all Owner furnished material after their transfer to Contractor.
- D. Immediately after installation, lubricate components in accordance with manufacturer's instructions.
- E. Follow manufacturer's instructions for protection and maintenance until final acceptance of the Project.

- F. Furnish incidental supplies including lubricants, cleaning fluids, and similar products as needed for protecting and maintaining the Owner furnished material.

## PART 2 - PRODUCTS

### 2.1 OWNER-FURNISHED/CONTRACTOR-INSTALLED (OFCI) PRODUCTS

A. Products Identified with Contractor Responsibility for Installation:

1. Contractor shall verify mounting and utility requirements for accepted products.
2. Contractor shall provide mounting and utility rough-ins for OFCI products.
  - a. Rough-in locations, sizes, capacities and similar type shall be as indicated and required by product manufacturers.
  - b. If the Owner substitutes items similar to those scheduled there shall be no change in rough-in cost, unless substitution occurs after rough-in has been completed or rough-in involves other mounting requirements, utilities of different capacity than those required by item originally specified.
3. For items Designated to Be Owner- or Vendor-Furnished: Owner or its vendor will furnish manufacturer's literature or information, shop drawings, or appropriate information for preparing required shop drawings.

B. Installation Instructions: Approved manufacturer's printed descriptions, specifications and recommendations shall govern the Work, unless specifically indicated otherwise.

C. Requirements Furnished by Owner and Installed by Contractor:

1. Contractor shall coordinate delivery of OFCI products. Owner will furnish products to coincide with construction schedule.
2. Owner will:
  - a. Furnish standard integral components of products.
  - b. Deliver products to site. Contractor shall assist Owner in offloading products.
3. The Contractor shall:
  - a. For the Custom Orlando Model Pavilion (attachment A) – Contractor shall include and furnish the Tennessee sealed structural engineering drawings and specifications for the structure, footings and foundations (to be provided by the manufacturer of the pavilion) for submittal to the city of Franklin permitting.
  - b. Receive products at site and give written receipt for product at time of delivery, noting visible defects and omissions; if such declaration is not given, the Contractor shall assume responsibility for such defects and omissions.
  - c. Store products until ready for installation and protect from loss and damage.
  - d. Uncrate, assemble and set products in place.

- e. Install products in accordance with manufacturer's recommendations, instructions and shop drawings under supervision of manufacturer's representative where specified, supplying labor and material required and making mechanical, plumbing and electrical connections necessary to operate equipment.
  - f. Where so specified, installation shall be only by installer approved by manufacturer. If known, approved installer is identified on the Drawings or in the Specifications.
  - g. Provide and install backing for all products weighing 20 pounds or more.
  - h. Treat all Owner or Vendor supplied products with the same care as all Contractor furnished items.
4. The following items are included in the Owner furnished materials and will be provided at no cost to the Contractor to install:

- a. Playground pavilion (See Attachment A for specific pavilion information and architectural IP- series drawings) – including all footings, foundations, materials, equipment, accessories, labor, and incidentals to furnish and install playground pavilion. Architectural drawings shall take precedent where conflicting information exist between manufacturer and construction documents.

Supplier: Classic Recreation Systems, Inc./ Recreational Concepts  
Contact: Shelia Stewart, (931) 303- 0227, [shelia@rec-concepts.com](mailto:shelia@rec-concepts.com)

- b. Riparian Buffer Signage as described on Detail 1 Sheet L1.00 will be provided by the City of Franklin to be installed by the contractor.
- c. Athletic Field Scoreboards and Play Clocks - Includes scoreboard and play clock materials and equipment delivered to project site to be received and installed by the contractor.
  - 1) Contractor to provide all footings, foundations, materials, equipment, conduit, wiring, and incidentals to install score boards and play clocks provided by the Owner.

Supplier: Fair-Play  
Contact: Jeff Hamblen, (615) 513-9618, [mtscore@gmail.com](mailto:mtscore@gmail.com)

- d. Lightning Detection System – Includes lightning detection system materials and equipment delivered to the project site to be received and installed by the contractor.
  - 1) Contractor to provide all footings, foundations, materials, equipment, conduit, wiring, and incidentals to install lightning detection system provided by the Owner.

Supplier: Thor Guard  
Contact: Tim Beard, 615-347-5180

---

## 2.2 OWNER-FURNISHED/OWNER-INSTALLED (OFOI) PRODUCTS

### A. Products Furnished and Installed by Owner's Vendor:

#### 1. Contractor and Owner's Vendor responsibilities:

- a. General: Contractor shall coordinate deliveries of vendor-supplied products. Vendor will furnish products to coincide with the construction schedule.
- b. Vendor will:
  - 1) Furnish standard integral components of products.
  - 2) Deliver products to site.
  - 3) Make connections to roughed-in utilities.
- c. Contractor shall:
  - 1) Receive products at site and give written notice of receipt of each product at time of delivery, noting visible defects.
  - 2) Provide rough-in of utility products in accordance with manufacturer's recommendations, instructions and shop drawings under supervision of the manufacturer's representative where specified.
  - 3) Provide and install backing for all products weighing 20 pounds or more.

#### 2. The following items are included in the OFOI materials and will be provided and installed at no cost to the Contractor:

##### a. Main Park

- 1) WiFi Access – including all accessories, incidentals, labor, materials, equipment, and necessary subsystems required to furnish and install each complete and fully functional WiFi access point.

Contact: City of Franklin IT Department

- 2) Security Cameras – including pole, camera, subsystems, accessories, incidentals, labor, materials and equipment to furnish and install a complete and functional surveillance camera system.

Contact: City of Franklin IT Department

- 3) Tornado Siren – including all accessories, incidentals, labor, materials, equipment, and necessary subsystems required to furnish and install a complete and fully functional siren system.

Contact: City of Franklin IT Department

##### b. Inclusive Playground

- 1) Playground shade canopies (See Attachment A for shade canopy information) – including all footings, foundations, materials, equipment, accessories, labor, and incidentals to furnish and install playground shade canopies.

Supplier: Landscape Structures, Inc./ Recreational Concepts  
Contact: Shelia Stewart, (931) 303- 0227, shelia@rec-concepts.com

- 2) Playground equipment (See Attachment A for specific playground equipment information) – including all footings, foundations, materials, equipment, accessories, labor, and incidentals to furnish and install playground equipment.

Supplier: Landscape Structures, Inc./ Recreational Concepts  
Contact: Shelia Stewart, (931) 303- 0227, shelia@rec-concepts.com

- 3) Synthetic Turf Surfacing (See Details 4 and 5 Sheet L7.04) – including all base stone, synthetic turf, materials, equipment, accessories, labor, and incidentals from subgrade established by general contractor to proposed finish grade to furnish and install complete synthetic turf system.

- a) General Contractor to provide earthwork to establish subgrade, subsurface drainage, concrete curb edging, concrete sidewalks, river stone mulch and associated base materials for these items including all labor, materials, and incidentals to furnish and install these items.

- b) Subgrade preparation by general contractor shall comply with surfacing manufacturer's specifications.

Supplier: Landscape Structures, Inc./ Recreational Concepts  
Contact: Shelia Stewart, (931) 303- 0227,  
shelia@rec-concepts.com

- 4) Poured-In-place (PIP) Surfacing (See Details 1 and 2 Sheet L7.04) – including all base stone, PIP surfacing, materials, equipment, accessories, labor, and incidentals from subgrade established by general contractor to proposed finish grade to furnish and install complete PIP surfacing system.

- a) General Contractor to provide earthwork to establish subgrade, subsurface drainage, concrete curb edging, concrete sidewalks, river stone mulch and associated base materials for these items including all labor, materials, and incidentals to furnish and install these items.

- b) Subgrade preparation by general contractor shall comply with surfacing manufacturer's specifications.

Supplier: Landscape Structures, Inc./ Recreational Concepts



---

Contact: Shelia Stewart, (931) 303- 0227,  
shelia@rec-concepts.com

c. Athletic Fields

- 1) Synthetic Turf Athletic Field (See Detail 3 Sheet L7.02) - including all base stone, concrete header curb edging, subsurface drainage, synthetic turf, materials, equipment, accessories, labor, and incidentals from subgrade established by general contractor to proposed finish grade to furnish and install complete synthetic turf athletic field system.

Supplier: Field Turf  
Contact: Neil O'Donnell, (615) 665-1495

- 2) Sports Field Lighting (See Attachment B for additional sports field lighting information) - including all footings, foundations, materials, light pole, light fixtures, contactor cabinets, controls, equipment, accessories, labor, wiring harness, wire connections to furnish and install complete sports field lighting.

- a) Contractor to provide branch circuit, conduit and wiring to each pole location with enough wiring to extend 12' above grade at each pole location.

Supplier: Musco Lighting, LLC  
Contact: Greg Gilley, (641) 660-2362, [Greg.gilley@musco.com](mailto:Greg.gilley@musco.com)

- 3) MuscoVision Audio-Video (AV) System (See Attachment B for additional AV System information) - including all footings, foundations, materials, poles, fixtures, equipment, accessories, internal wiring, labor, wire connections to furnish and install complete AV system.

- a) Contractor to provide branch circuit, conduit and wiring to each pole location with enough wiring to extend 12' above grade at each pole location.

Supplier: Musco Lighting, LLC  
Contact: Greg Gilley, (641) 660-2362, [Greg.gilley@musco.com](mailto:Greg.gilley@musco.com)

- d. For further information, contact the Supplier.

## PART 3 - EXECUTION

### 3.1 SURFACE CONDITIONS

- A. Inspection:

1. Prior to commencing Work, Contractor shall verify that Work specified in other Sections has been properly completed and installed as specified to allow for installation of all materials and methods required of this Section.
2. Contractor shall verify that new and existing products and conditions are satisfactory for installation or relocation of OFCI products. If unsatisfactory conditions exist, do not commence the installation until such conditions have been corrected.

B. Discrepancies:

1. In the event of discrepancy, Contractor shall immediately notify the Owner's Representative.
2. Contractor shall not proceed with installation in areas of discrepancy until all such discrepancies have been resolved.

### 3.2 INSTALLATION

- A. Install products in conformance with Seller furnished shop drawings and manufacturer's installation instructions.
- B. Provide all interconnecting structures, equipment, piping, electrical and instrumentation work, finish painting, and appurtenances to achieve a complete and functional system.
- C. Provide foundation pads as shown on Drawings. Verify exact dimensions and configuration of all pads, including penetrations, with Seller furnished shop drawings.
- D. Anchor Bolts
  1. Where required, provide anchor bolts, fasteners, washers, and templates needed for installation of Owner furnished equipment.
  2. Size and locate anchor bolts in accordance with Seller furnished shop drawings and manufacturer's installation instructions.

### 3.3 FIELD FINISHING

- A. Products will be delivered with coating as specified in Section 099113, Painting.
- B. Touch up or repair damage to coatings resulting from unloading, storage, installation, testing, and startup.
- C. If finish coats are damaged extensively after transfer, completely repaint.
- D. Touch up, repair, or complete repainting shall match color of original paint, and shall be fully compatible with applied primers and finish.

3.4    TESTS AND INSPECTION

- A.    Perform tests and inspections of installed products in accordance with Specifications and manufacturer's instructions.

END OF SECTION 016400

# Section 016400 Attachment A

**Enlarged Playground  
Equipment Drawings,  
Pavilion, and Shade  
Canopies**

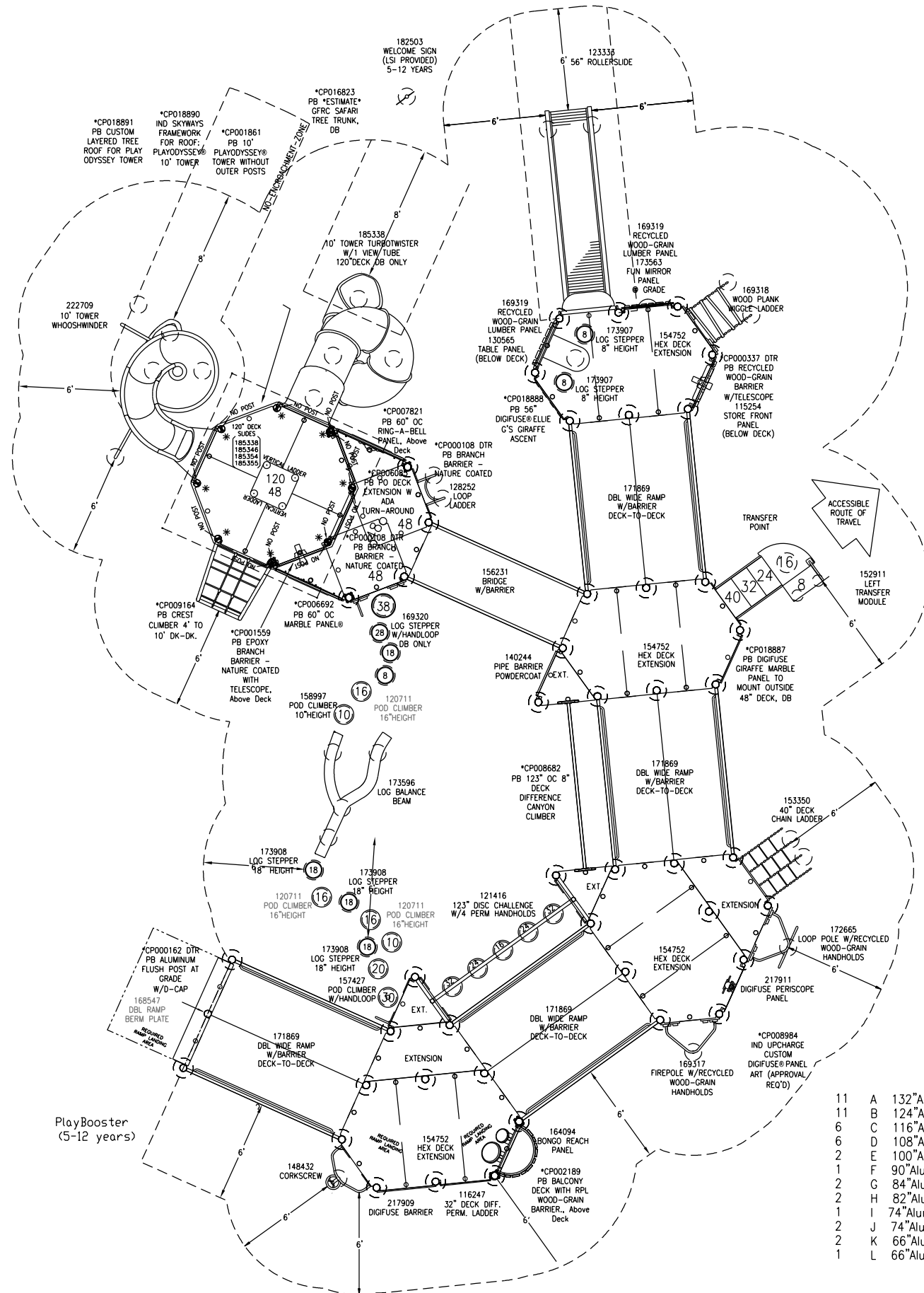

- 11 A 132\"/>

PLAY AREA #1 - COMPOSITE STRUCTURE

N.T.S

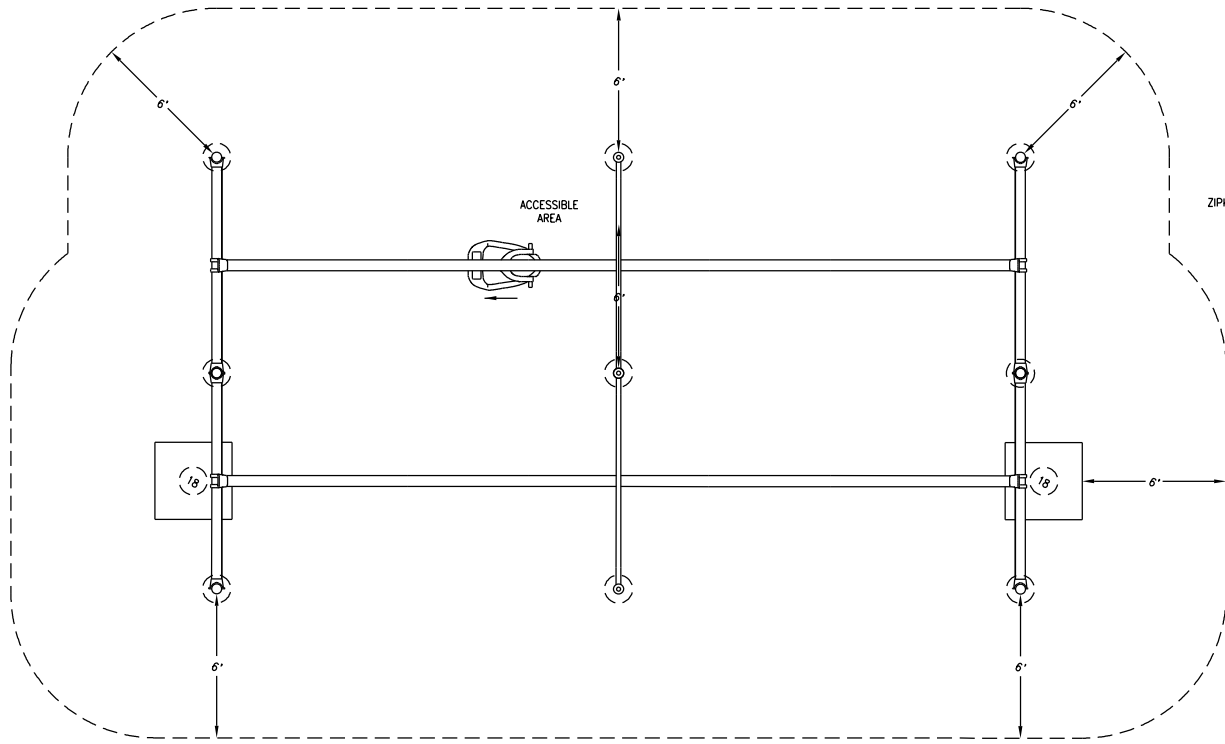

PLAY AREA #1 - ZIPKROOZ W/ ADDITIONAL BAY AND INTEGRATED SHADE

N.T.S

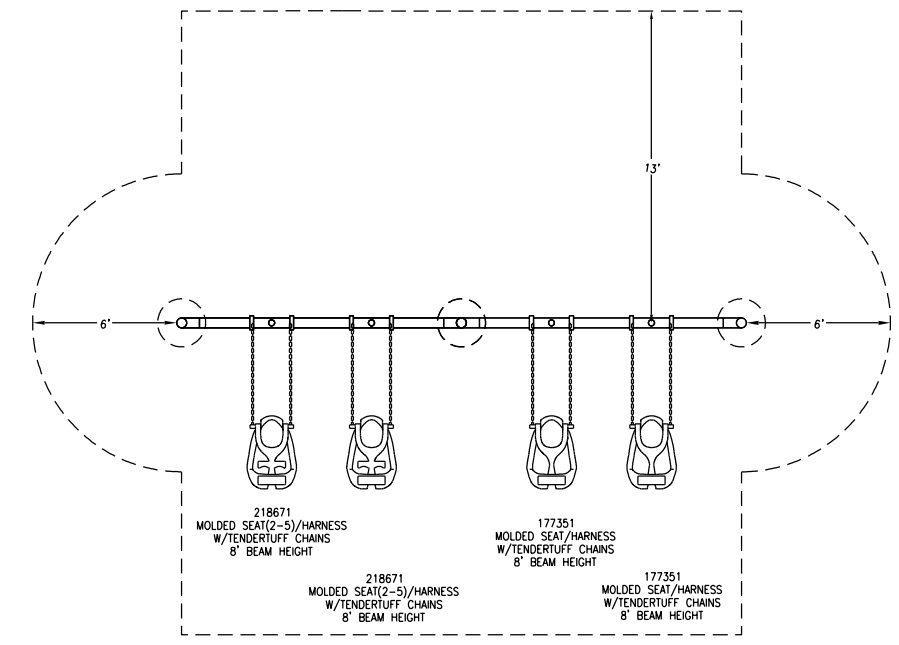

PLAY AREA #1 - ARCH SWINGS W/ ADDITIONAL BAY AND INTEGRATED SHADE

N.T.S

LANDSCAPE STRUCTURES PLAYGROUND EQUIPMENT

SOUTHEAST MUNICIPAL COMPLEX  
CITY OF FRANKLIN  
WILLIAMSON COUNTY, TENNESSEE

ATTACHMENT B

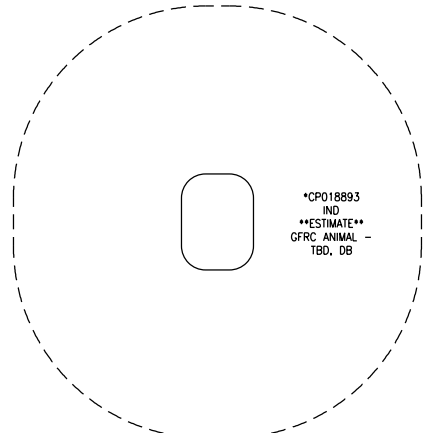
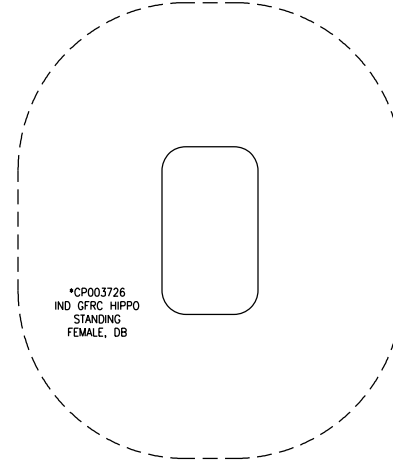
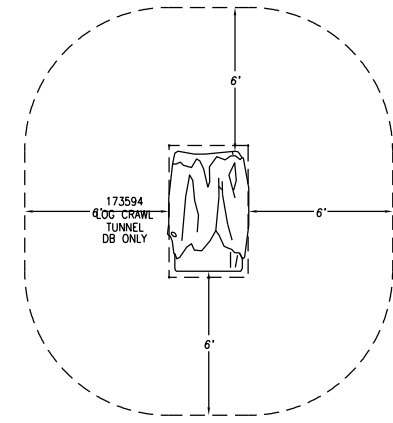
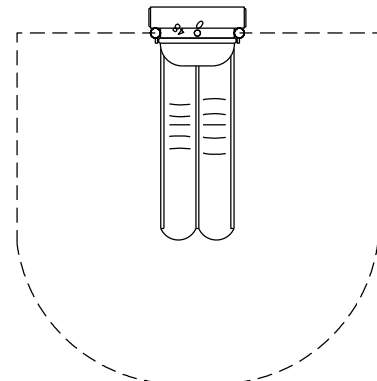
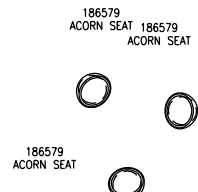
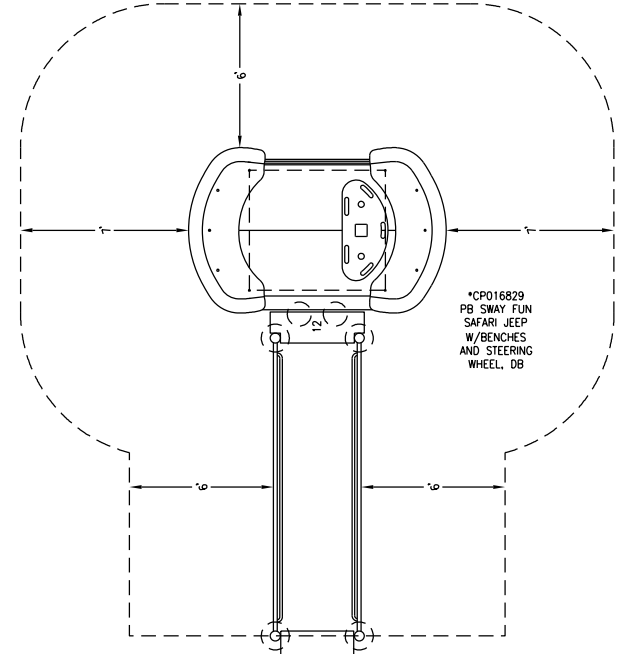
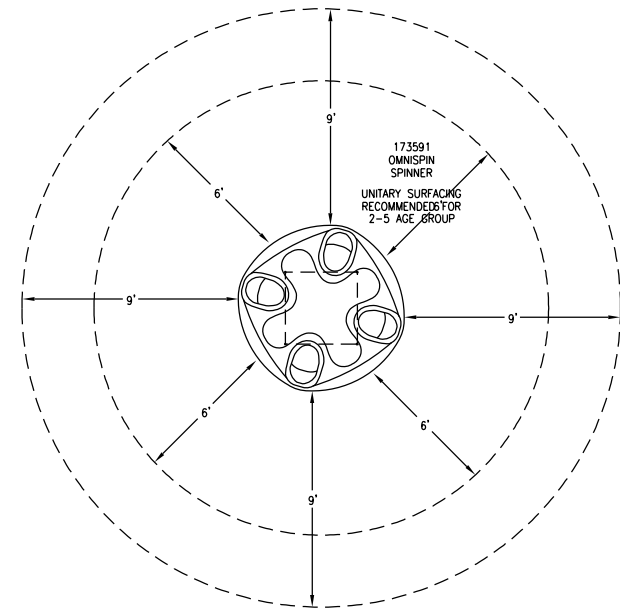
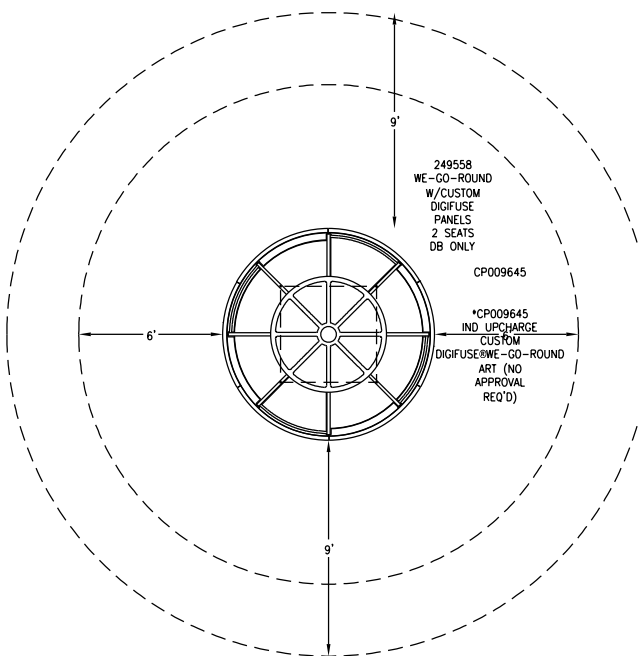
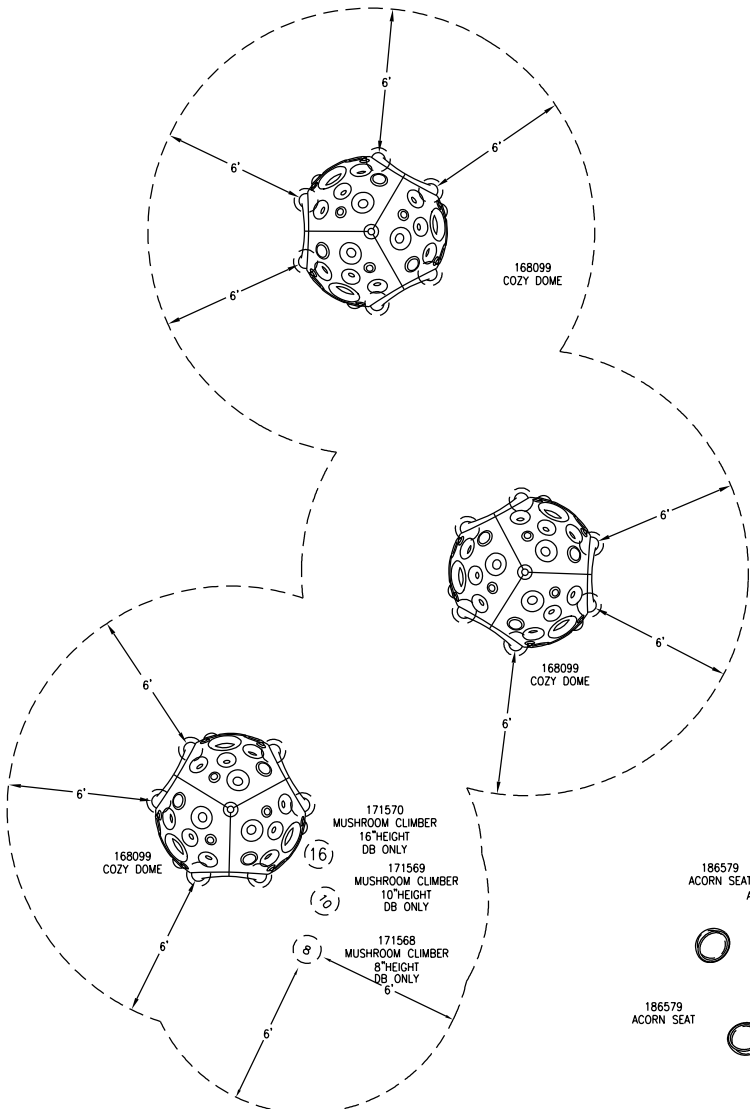
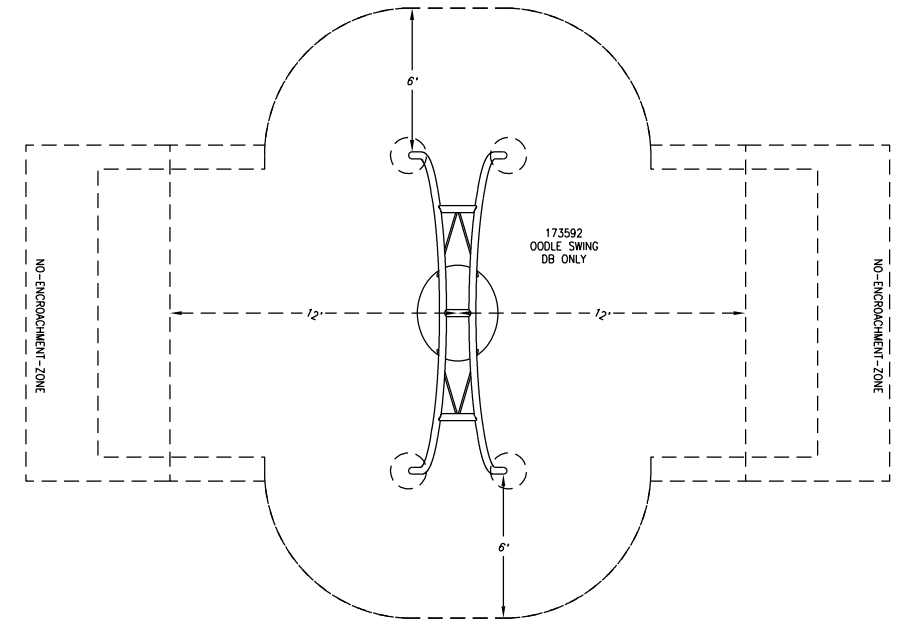
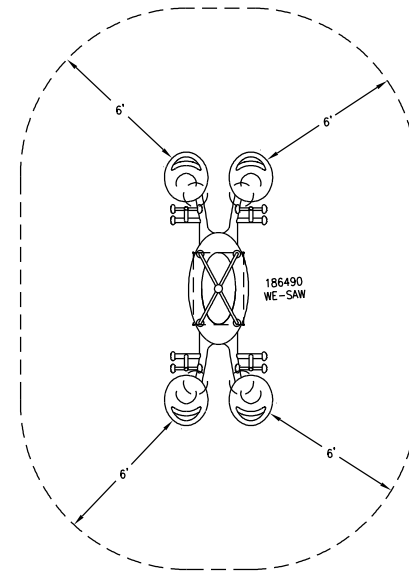
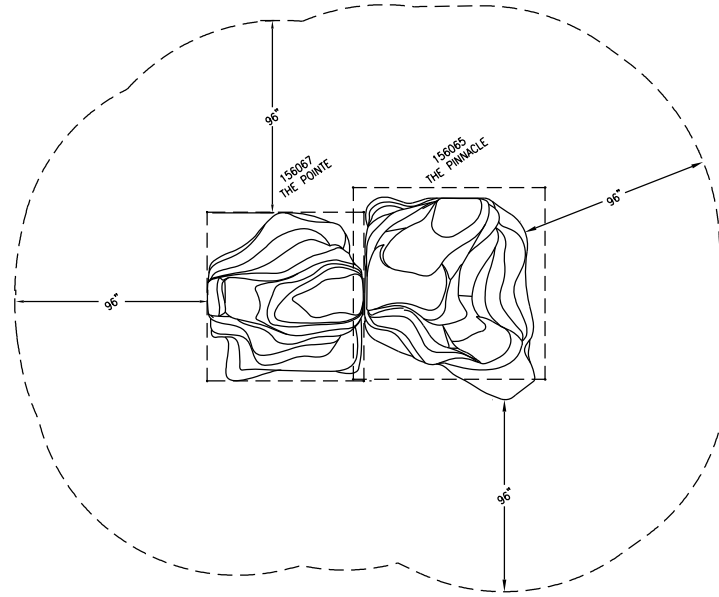
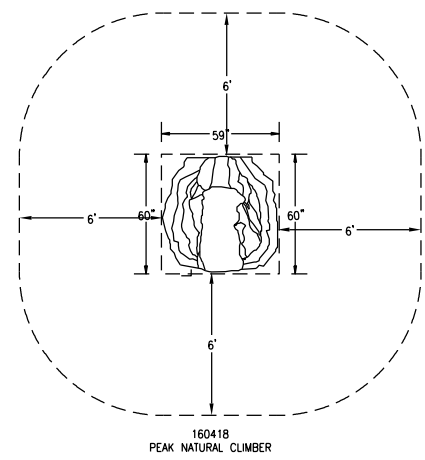

PLAY AREA #1 - FREESTANDING EQUIPMENT

N.T.S

LANDSCAPE STRUCTURES PLAYGROUND EQUIPMENT

SOUTHEAST MUNICIPAL COMPLEX  
CITY OF FRANKLIN  
WILLIAMSON COUNTY, TENNESSEE

ATTACHMENT B

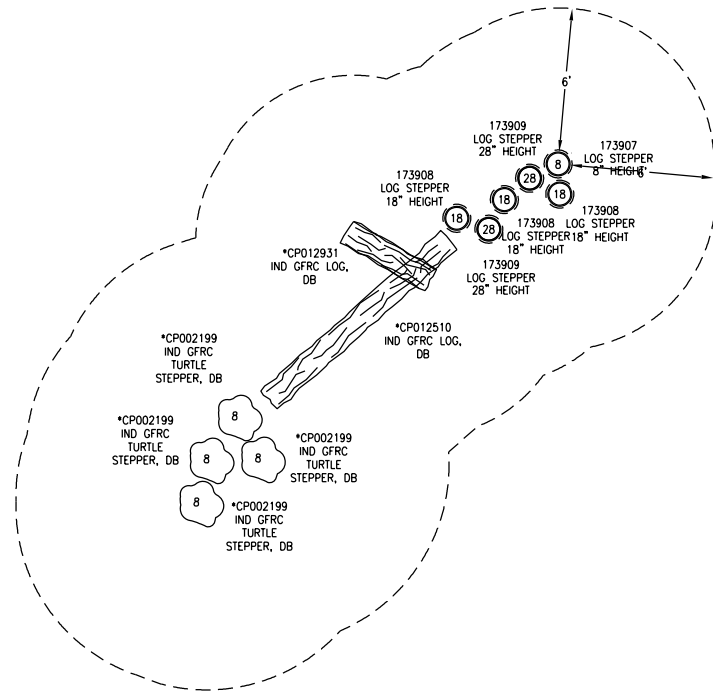

**PLAYGROUND AREA #1 - FREESTANDING EQUIPMENT**

N.T.S

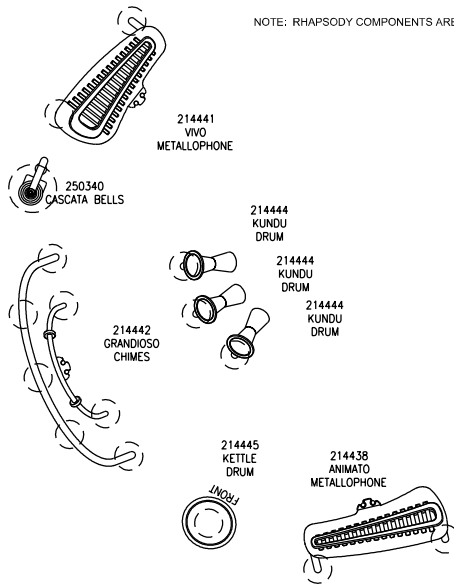

NOTE: RHAPSODY COMPONENTS ARE NOT IPEMA CERTIFIED.

**PLAYGROUND AREA #2 - MUSIC AREA**

N.T.S

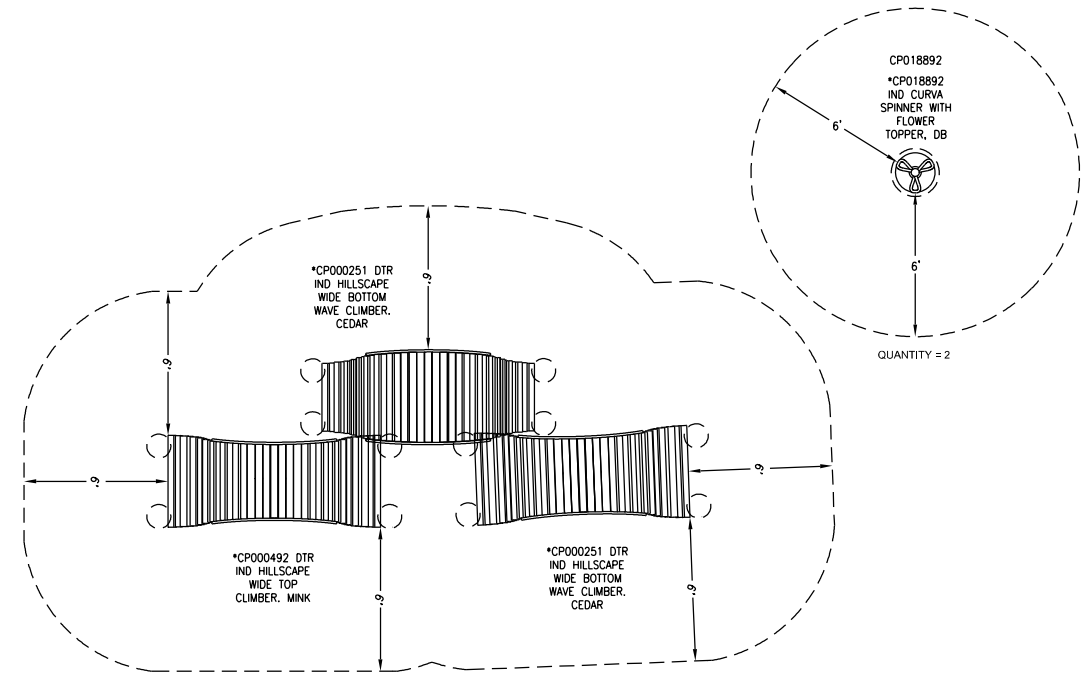

**PLAYGROUND AREA #3 - SAVANNAH AREA**

N.T.S

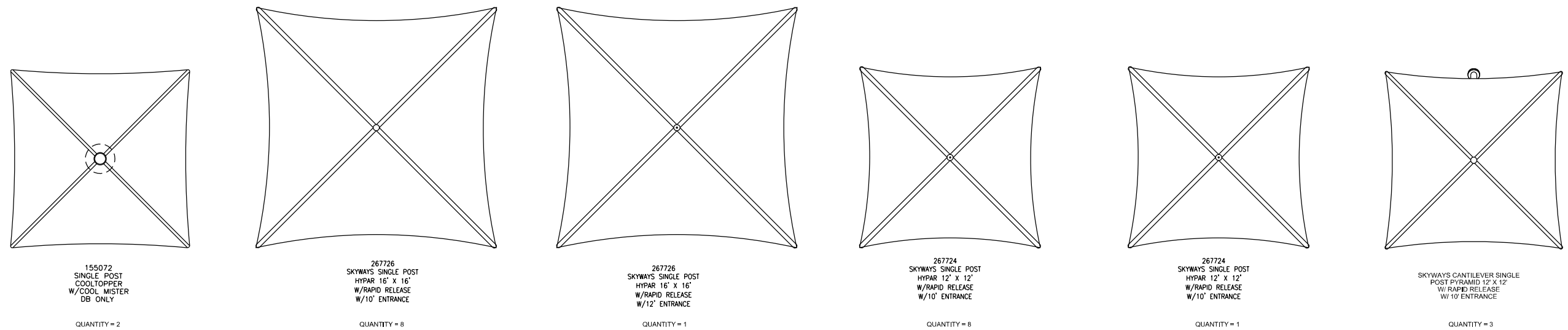

NOTE: THE SKYWAYS SINGLE POST HYPAR IS NOT IPEMA CERTIFIED.

**SHADE CANOPIES**

N.T.S



## CUSTOM ORLANDO MODEL

40' X 109'-5"

## SPECIFICATIONS

## Dimensions:

Roof Dimensions	40'-0" x 109'-5"
Column Dimensions (Center to Center)	Varies
Minimum Clearance	8'-4"
Roof Height @ Ridge	+/- 18'-2" <del>+14'-6 1/8"</del>
Gable Roof	6:12 <del>4:12</del> pitch
Square Feet Under Roof	±5123
Date of drawings	July 30, 2020

Columns shall be 8" x 8" steel tube, minimum .188 wall thickness.

Columns shall be (4) 4" quad steel tube minimum .125" wall thickness.

All beams shall be structural steel tube sized according to engineering.

All bolts shall be A-325 or A-307 and hidden at all connections.

Roofing shall be 24 gauge 16" OC Standing Seam steel pre-cut and pre-finished with ribs running with the slope of the roof.

~~Optional~~ sub-roof shall be select grade SPF 2" x 6" Tongue & Groove rough one side.

Fascia shall be steel tube.

Open or welded "C" channel, "I" beams, "S" or "Z" purlins or angle iron shall not be allowed.

Verrado stile trusses throughout structure.

MANUFACTURER SHALL PROVIDE SEALED DRAWINGS FOR THE PAVILION STRUCTURE AND FOUNDATIONS. STATE OF TENNESSEE SEAL REQUIRED.

MANUFACTURER AND CONTRACTOR SHALL USE THE PROJECT DOCUMENTS SEALED AND DATED APRIL 19, 2024 - DRT & PERMIT RESUBMITTALS / BIDS AND WITH THE CITY OF FRANKLIN APPROVAL STAMP DATED 05/13/2024 AS THE DESIGN DOCUMENTS FOR THE PAVILION. ARCHITECTURAL DRAWINGS SHALL TAKE PRECEDENCE OVER THESE PROPOSED (NOT FOR CONSTRUCTION) DRAWINGS FROM THE MANUFACTURER WHERE CONFLICTING INFORMATION EXIST.

Ph: (928) 775-3307 Fax: (928) 772-0858

[info@classicrecreation.com](mailto:info@classicrecreation.com)

[www.classicrecreation.com](http://www.classicrecreation.com)





**STANDARD SPECIFICATIONS**  
**16" O.C. STANDING SEAM ROOF**  
**w/ ZINC RICH PRIMER**  
**& POWDER COAT**

**GENERAL:**

1. All structures shall be designed and fabricated to the IBC (~~Latest Edition~~ <sup>2018 Edition</sup>) or current local building code with standard load designs of the greater value of 20# per S.F. minimum live load and 115 mph sustained wind load or site specific conditions and the applicable zone for seismic loads.
2. All members shall be designed according to the "American Institute of Steel Construction (AISC) specifications and the American Iron and Steel Institute (AISI) specifications for cold-formed members.
3. All fabrication welds shall be in strict accordance with the structural welding code of the American Welding Society (AWS) specifications. All structural welds shall be in compliance with the requirements of "Pre-qualified" welded joints. All welding shall conform to ASTM A-233 series E-70XX electrodes - low hydrogen.  
*Field welding shall not be required.*
4. ~~When required, after award of bid,~~ the shade structure manufacturer shall submit structural calculations, sealed by a registered engineer in the state in which the structure is to be erected for review and approval by the approving agency.
5. Manufacturer qualifications: All manufacturers shall have a minimum of (20) twenty years experience in the fabrication of tubular steel shade structures. Shade structure and kiosk fabrication shall be the manufacturer's primary business. Manufacturer shall have fabricated similar structures to that which is specified. All non-specified manufacturers shall submit complete shop drawings indicating type, size & gauge of material used, with detailed connections to the specifying agency or design firm at least 10 days prior to bid opening for review and written pre-approval. All bids submitted without prior approval will be rejected.

**FOOTINGS & COLUMNS:**

1. Footings shall be structurally engineered by the structure manufacturer to meet local codes and site conditions. (Sample footing drawings shall be made available to the contractor or owner from the manufacturer). Anchor bolts for surface mounted structures shall be supplied by the ~~owner~~/ contractor. Columns shall be ASTM 500 grade B. Concrete footing rebar (if required) shall be ASTM A-615 grade 40 #4 bars & smaller, grade 60 #5 bars & larger. Concrete shall be 5 sack mix "Portland" cement. Maximum slump shall not exceed 4". Compressive strength: 2500 psi @ 28 days

**FRAME MEMBERS AND COMPRESSION RING:**

1. 90% American (domestic) made steel shall be used in the construction of this shelter. Mill certification shall be made available upon request. All frame members shall be one piece structural steel tube with a minimum .120 (1/8") wall thickness, sized according to engineering. All frame members shall be bolted together with bolts totally concealed. All tubing for frame members shall be ASTM 500 grade B. Beam end plates shall be ASTM A36 fy=36,000 psi UNO. Bolts shall be A 307's, or 325's unless noted otherwise.  
*"I" beams, Angle iron, "C", "Z" or "S" purlins or beams, open or closed, shall not be allowed.*



### ROOFING AND TRIM:

1. All roofing shall be 24 gauge Zincalume / Galvalume coated steel panels. "Standing Seam" panels shall be Design Span by AEP Span, with 1¾" high ribs @ 16" o.c. All roofing shall be pre-finished with Duratech 5000 or equal, 30 year paint finish. All roof panels shall be pre-cut with ribs running with the slope of the roof. Fascia shall be tube steel min. .120 (1/8") wall thickness. Trim shall be 24 gauge Zincalume / Galvalume coated pre-finished to match the roof color. Screws & rivets shall match roof color.

### SUB-ROOF & FASCIA:

1. ~~Optional~~ sub-roof shall be 2"x 6" tongue and groove, select grade SPF, rough 1 side. T&G shall be screwed to the frame with (1) #12-24 x 2½" Phillip flat head w/ wings. (One screw per board per beam connection). Fascia shall be tube steel.

### POWDER COATING:

1. All frame members shall be media blasted to a white finish removing all rust, scale, oil and grease. Powder coating for all frame members shall be provisionally warranted for (10) ten years with **TRUZINC** 7520-70138 primer with a Dry Film Thickness of (2.0 - 6.0 mils) & hardness of 2H-3H with a Salt Spray Resistance of **6000 hours** and **Super Durable Gloss Polyester 9000** series finish paint (2.5-3.5 mils) with a hardness of H-H2 & has **1000 hour** salt spray resistance. Total of primer & finish paint shall be 4.5-9.5 mils of paint. Finish shall be a smooth uniform surface with no pits, runs or sags. For additional information, please visit <http://www.tcipowder.com/> for a complete list of specifications.

### ERECTION:

1. Manufacturer shall supply complete layout and detail plans with installation instructions for the structure. The structure shall be erected in a work-man-like manner with framing, roofing and trim installed according to the manufacturers' installation instructions. Care shall be taken to avoid damaging the structure during installation. Components of the structure shall be covered and kept dry prior to erection.

### WARRANTEE:

1. Manufacturer shall warranty the structure to be free from defects in material and workmanship for a period of (10) ten years from date of acceptance by owner. Warranty does not include damage from theft, fire, vandalism or acts of God. Manufacturer shall repair or replace structure components of like kind at his option, to match existing material and workmanship. Steel roof finish shall be warranted for (30) thirty years under a separate roof manufacturer's warranty. Powder coat paint shall be warranted for (10) ten years after acceptance from owner against peeling, flaking and rusting. Warranty does not cover damage caused from shipping, erection of structure, lack of touchup and maintenance, overspray from lawn sprinklers or vandalism. Bolt threads are not powder coated and therefore are not covered under the powder coat warranty.

*NOTE: Engineering specifications take precedence over drawings if differences occur.*

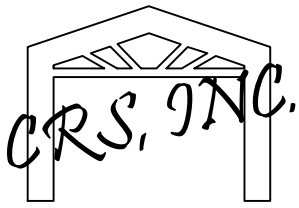

# NOT FOR CONSTRUCTION

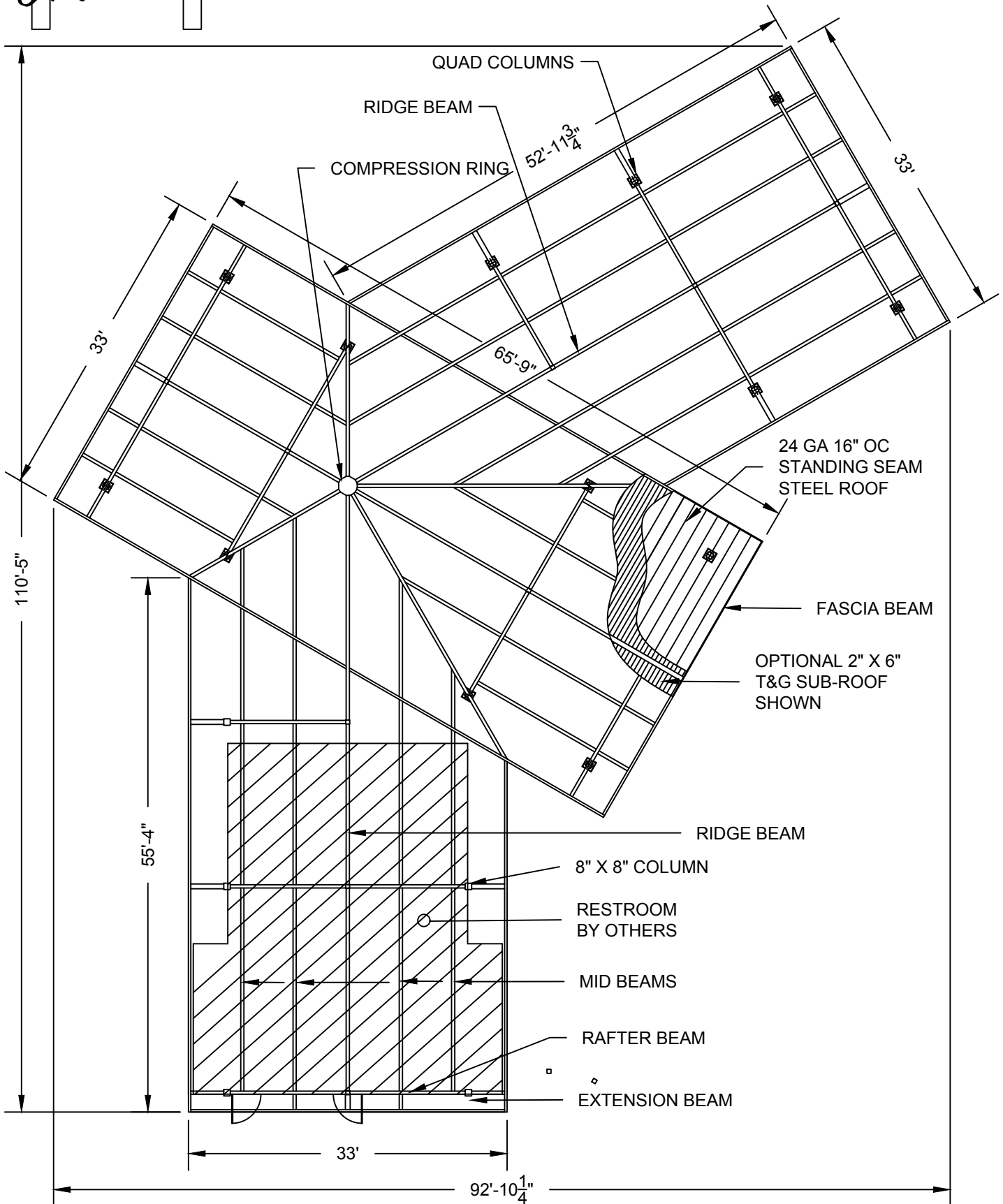

PLAN VIEW 40' X 109'-5" CUSTOM ORLANDO MODEL  
NTS

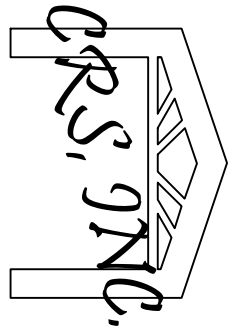

NOT FOR CONSTRUCTION

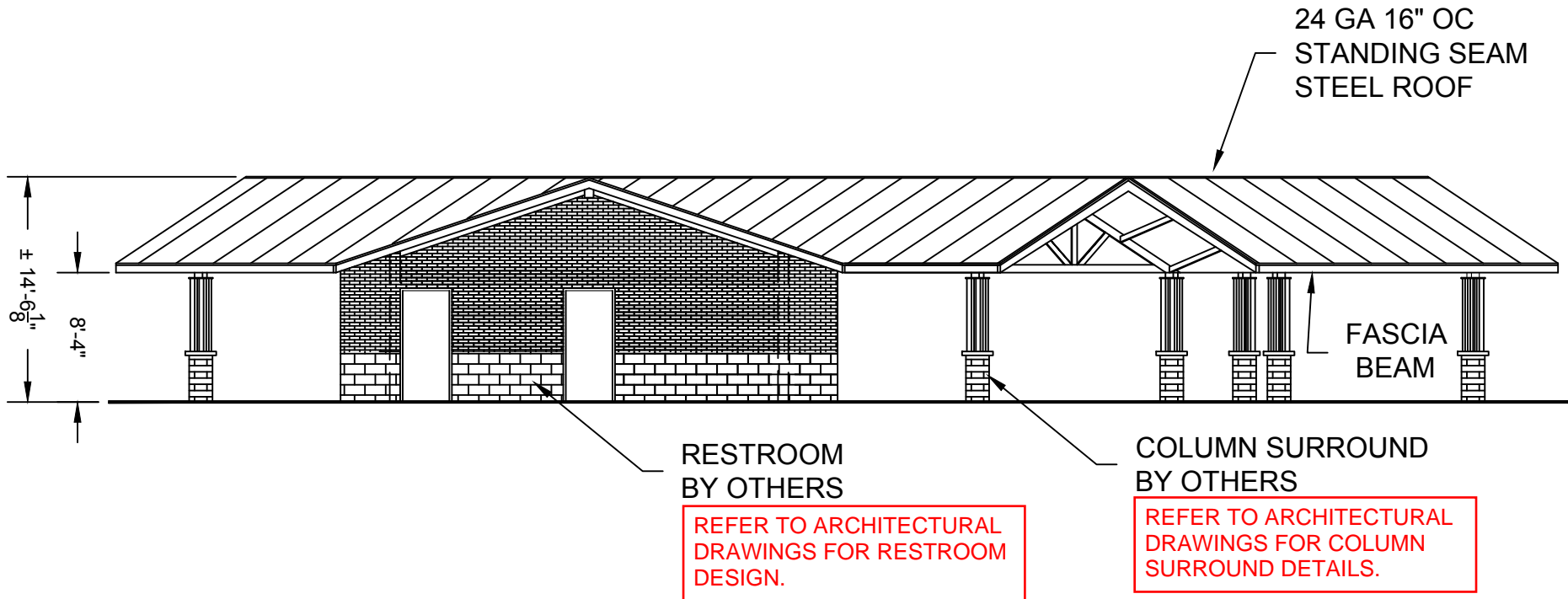

PAVILION SOUTH ELEVATION  
40' X 109'-5" CUSTOM ORLANDO NTS

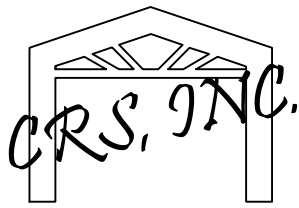

ATTACHMENT B

NOTE: FOR ILLUSTRATION ONLY!  
FOOTING SIZE MAY CHANGE w/  
STRUCTURAL ENGINEERING

ADJUST FTG DEPTH FOR  
LOCAL FROST CONDITIONS

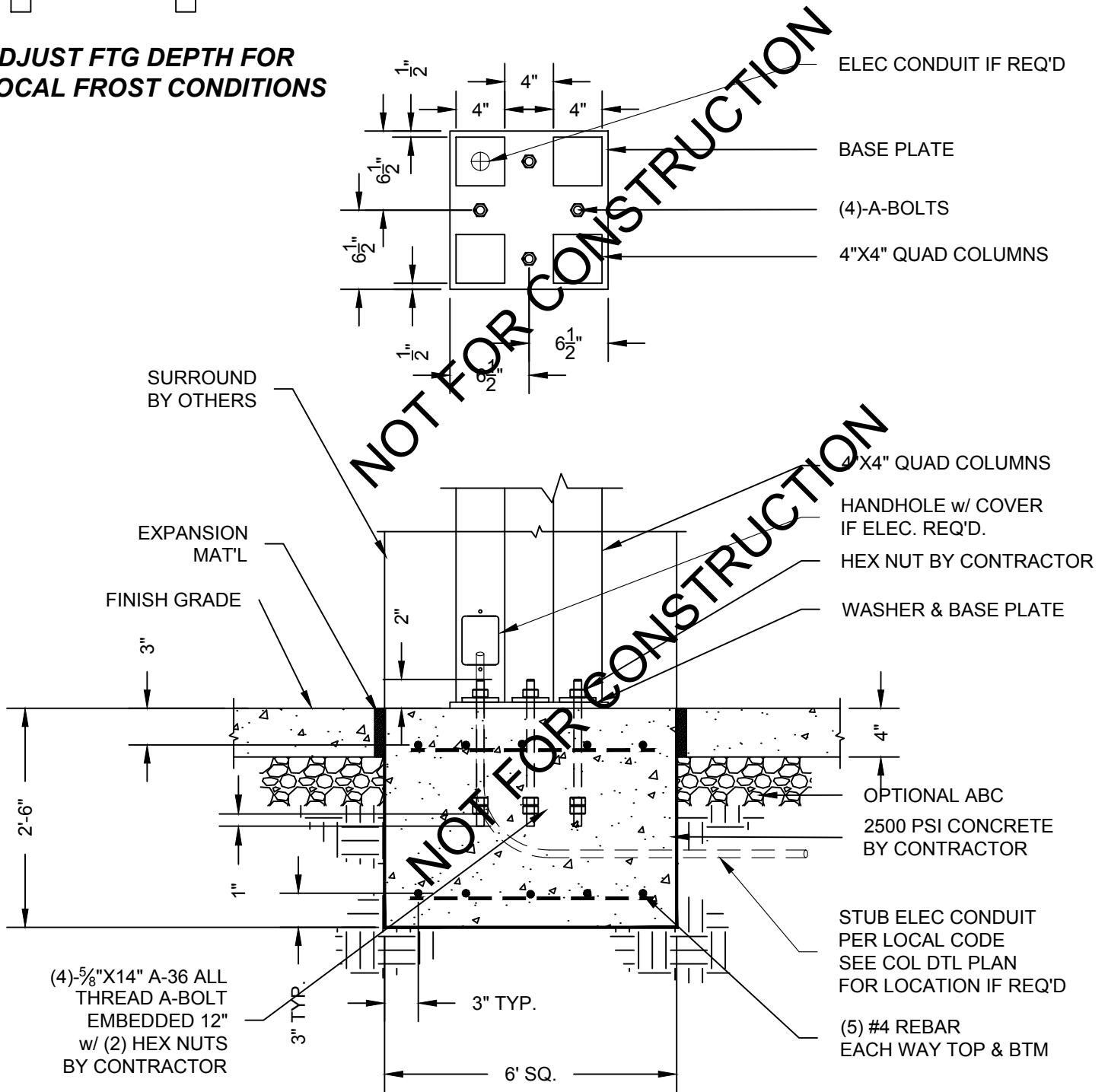

**NON-EXPANSIVE,  
UNDISTURBED OR 95%  
COMPACTED SUBGRADE**

**4-BOLT QUAD SURFACE MOUNT SPREAD FOOTING  
40' X 109'-5" CUSTOM ORLANDO MODEL  
NTS**

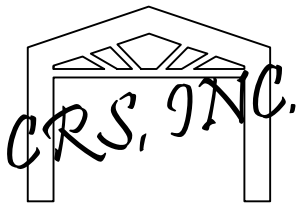

ATTACHMENT B

NOTE: FOR ILLUSTRATION ONLY!  
FOOTING SIZE MAY CHANGE w/  
STRUCTURAL ENGINEERING

ADJUST FTG DEPTH FOR  
LOCAL FROST CONDITIONS

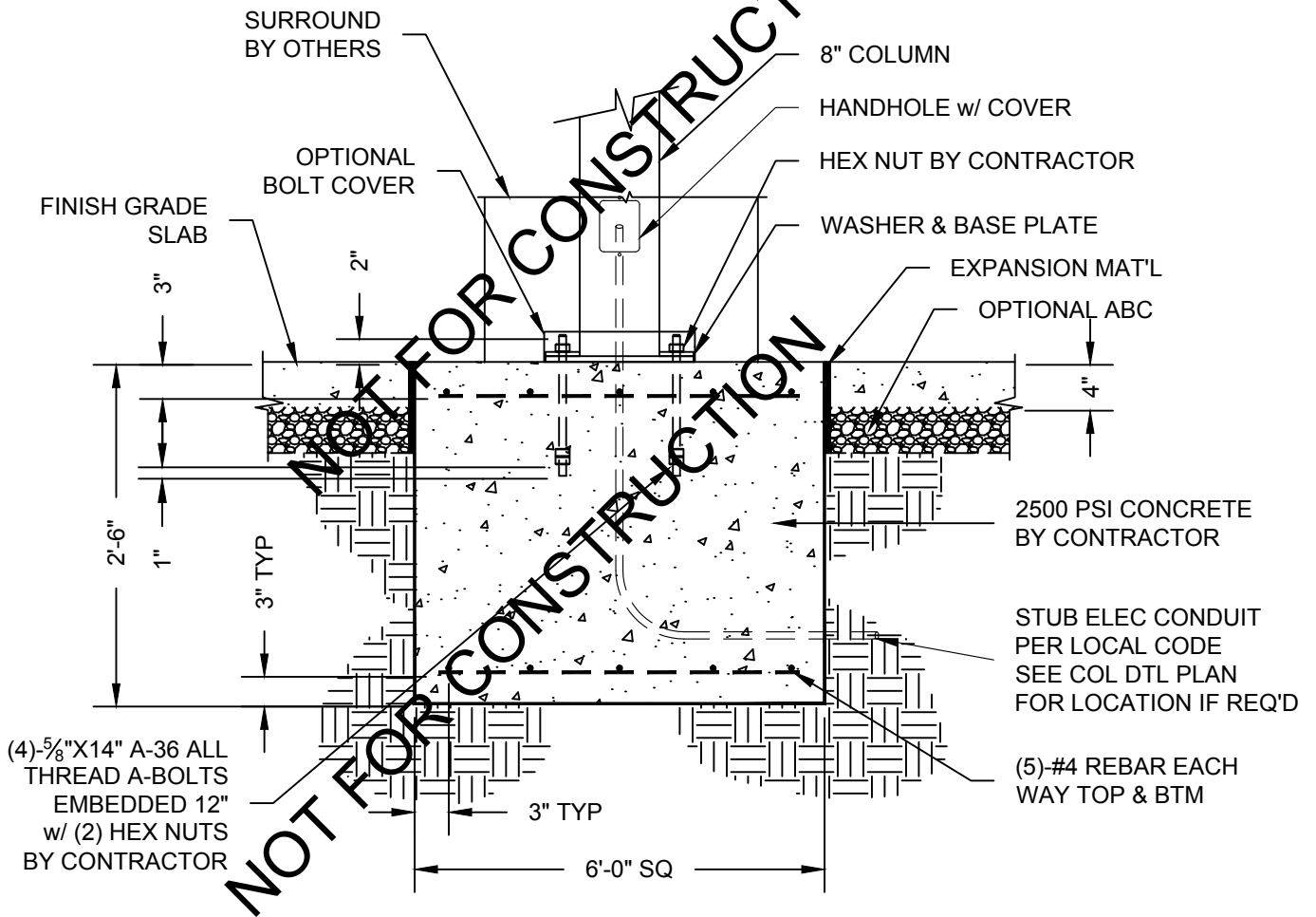
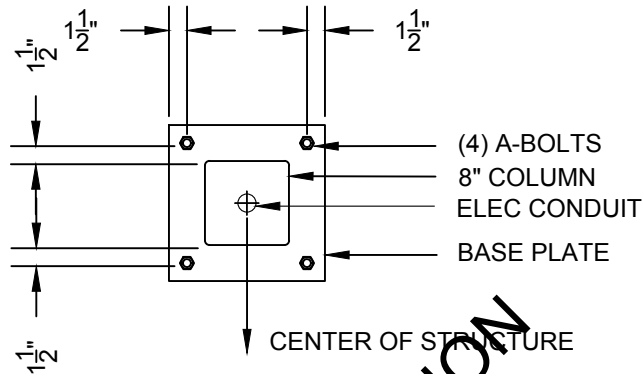

**NON-EXPANSIVE,  
UNDISTURBED OR 95%  
COMPACTED SUBGRADE**

**4-BOLT SURFACE MOUNT SPREAD FOOTING  
40' X 109'-5" CUSTOM ORLANDO MODEL  
NTS**

# Section 016400 Attachment B

## Musco Sports Field Lighting and MuscoVision Package

# System Requirements: Control System Summary

Project Name: Southeast Municipal Park Lacrosse | Project #: 200615

Control System ID: 1 of 1

Distribution Panel Location/ID: Service 1

## Project Information

### Control System

Control System ID: 1 of 1  
 Control System Type: Control-Link<sup>®</sup> Control and Monitoring System  
 Communication Type: PowerLine-ST

### Project Notes:

Fields 6-10 sent at a future date.

### Power Requirements

#### Control cabinet(s):

Control voltage (phase to neutral) 120/60  
 VA loading - Inrush 5718.0  
 VA loading - Sealed 622.0

#### Lighting Circuits:

Voltage/Hertz/Phase 480/60/3

### Equipment Listing

Description	Qty	Size (in)
Control and monitoring cabinet - primary	1	24 X 72
Control and monitoring cabinet - secondary	1	24 X 72

### Important Notes:

1. Please confirm that the lighting circuit voltage listed above is accurate for this facility. This is the voltage/phase being connected and utilized at each lighting pole's electrical components enclosure disconnect. Inaccurate voltage/phase can result in additional costs and delays. Contact your Musco sales representative to confirm this item.
2. In a 3 phase design, all 3 phases are to be run to each pole location. Musco's single phase luminaires come pre-wired to utilize all 3 phases across the entire facility.
3. One contactor is required for each circuit at each pole location. Contactors are 3 pole and 100% rated for the published continuous load.
4. If the lighting system will be fed from more than one distribution location, additional equipment may be required. Contact your Musco sales representative.
5. Size overcurrent devices using the full load amps column of the Circuit Summary by Switch chart (Minimum power factor is 0.9). Size conduit per code unless otherwise specified as larger to allow for harness connectors.
6. Avoid use of in-ground junction/pull boxes when possible. If used, all wire connectors must be UL listed for Wet Locations to prevent leakage current.
7. Control power wiring must be in separate conduit from line or load power wiring. Communication cables must be in separate conduit from any power wiring.
8. Refer to Installation Instructions for more details on equipment information and the installation requirements.



# System Requirements: Control System Summary

Project Name: Southeast Municipal Park Lacrosse | Project #: 200615

Control System ID: 1 of 1

Distribution Panel Location/ID: Service 1

## Equipment Layout and Connection Details



Lighting system

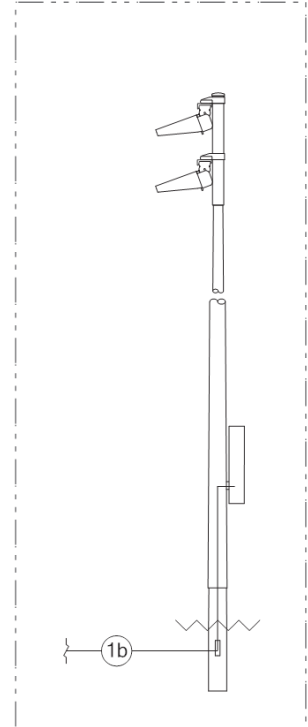

Control cabinet location

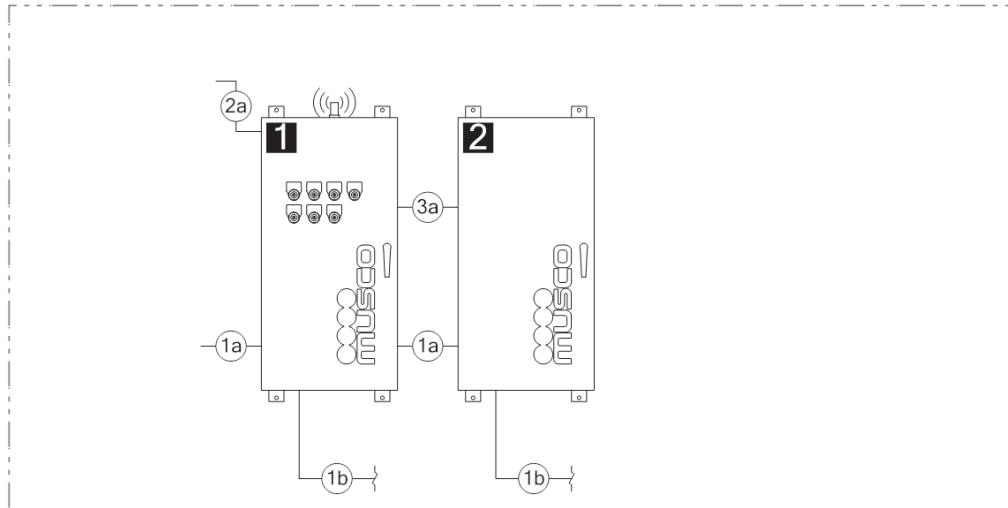

### Connection Details

ID	Description
1a	Line power to contactors, and equipment grounding conductor. Requires one circuit per contactor, size wiring per load and voltage drop.
1b	Load power from contactors, and equipment grounding conductor. Requires one circuit per contactor, size wiring per load and voltage drop.
2a	Control power with equipment ground to control cabinet. Requires dedicated 20 A circuit. Provide transformer if control voltage not present.
3a	Control harnesses - Secondary cabinet to primary cabinet. Harness is provided by Musco in 8-foot length. Use minimum 2 inch diameter conduit for harness connector.

### Equipment

ID	Description
1	Control and monitoring cabinet - primary
2	Control and monitoring cabinet - secondary

# System Requirements: Control System Summary

Project Name: Southeast Municipal Park Lacrosse | Project #: 200615

Control System ID: 1 of 1

Distribution Panel Location/ID: Service 1

## Circuit Summary

Switching Schedule	
Field/Switch Description	Switches
Security	7
Field 2	2
Field 5	5
Field 4	4
Field 1	1
Field 3	3

Control Module ID: 1

Lighting Circuit Voltage: 480/60/3

Circuit Summary by Switch							
Switch	Zone Description	Pole ID	Qty of Fixtures	Full load amperes	Contactor Size (Amps)	Cabinet #	Contactor ID
1	Field 1	S25	4	9.43	30	1	C1
	Field 1	S26	4	9.43	30	1	C2
	Field 1	S27	4	8.89	30	1	C3
	Field 1	S28	4	8.89	30	1	C4
2	Field 2	S23	5	12.03	30	1	C5
	Field 2	S24	5	12.03	30	1	C6
	Field 2	S25	5	12.03	30	1	C7
	Field 2	S26	5	12.03	30	1	C8
3	Field 3	S15	5	12.03	30	1	C9
	Field 3	S16	5	12.03	30	1	C10
	Field 3	S17	5	12.03	30	1	C11
	Field 3	S18	5	12.03	30	1	C12
4	Field 4	S21	4	9.43	30	2	C13
	Field 4	S22	4	9.43	30	2	C14
	Field 4	S23	4	9.43	30	2	C15
	Field 4	S24	4	9.43	30	2	C16
5	Field 5	S13	4	9.43	30	2	C17
	Field 5	S14	4	9.43	30	2	C18
	Field 5	S15	4	9.43	30	2	C19
	Field 5	S16	4	9.43	30	2	C20
7	Security	S13, S14, S15, S16, S17, S18, S21, S22, S23, S24, S25, S26, S27, S28	24	21.67	30	2	C23

## MuscoVision– Southeast Municipal Park

1. Mounting of MuscoVision Control Cabinets (Network and Automation Cabinets) – need to be installed so that they can have 120v and connection to Internet
2. Supply and installation of 120v dedicated 20amp circuit to the Networking Cabinet (s)
3. Termination of power between the Network and Automation Cabinets
4. Supply, installation, and termination of a Cat5 cable between the Network and Automation Cabinets
5. Supply, installation, and termination of Cat5 cable from Network Cabinet to customer's Internet location
6. Data cable runs to camera poles – depends on conduit routing distance:
  - a. Data cable distance of less than 300' from Network Cabinet to camera pole ECE = 2 – Cat5 shielded cables (Belden 7937A or equivalent) to each camera.

*OR*

- b. Data cable distance over 300' from Network Cabinet to camera pole ECE = 120v circuit to each camera pole ECE (1.5amp for single camera, 3amp for dual cameras) AND single mode fiber to each pole ECE
    - i. If fiber is needed, a fiber cabinet will also be installed near the network and automation cabinets

Equipment Description	
24	Light-Structure System™ Total Light Control™ TLC-LED-550 luminaires
14	Light-Structure System™ Total Light Control™ TLC-LED-1200 luminaires
74	Light-Structure System™ Total Light Control™ TLC-LED-1500 luminaires
12	80 ft galvanized steel poles
2	70 ft galvanized steel poles
14	Pre-cast concrete foundations (9,500 PSI) with integrated grounding
✓	Factory wired and assembled pole top luminaire assemblies
✓	Factory wired electrical component enclosures
✓	Factory built wire harnesses with plug-in connections
Controls	
2	24" x 72" Control and monitoring cabinet
✓	High/medium/low dimming
23	30-amp contactors
6	On-Off-Auto (OOA) switches
Warranty	
✓	Musco's Constant 25™ product assurance and warranty program that eliminates 100% maintenance costs for 25 years, including labor, materials, monitoring and guaranteed light levels.
Additional Items – Musco Vision	
4	30 ft galvanized steel poles
4	Pre-cast concrete foundations (9,500 PSI) with integrated grounding
6	Poletop camera assembly
✓	Factory wired electrical component enclosures
✓	Factory built wire harnesses with plug-in connections
Warranty – MuscoVision	
✓	Five year parts and labor for all MuscoVision components



**Southeast Municipal Park Lacrosse**  
Franklin, TN

Video System Equipment			
Type	Pop ID	Name	Location (X,Y,Z)
Cabinet	MV1	Cabinet Location	0, 150, 30
Camera	MV2	LSS30A	0, 135, 30
Camera	MV2	LSS30A	-4.4, 148.3, 30
Camera	MV4	LSS30A	-4.6, 140.1, 30
Camera	MV3	LSS30A	0, 140, 30
Camera	MV4	LSS30A	0, 140, 30
Camera	MV1	LSS30A	0, -172.8, 30

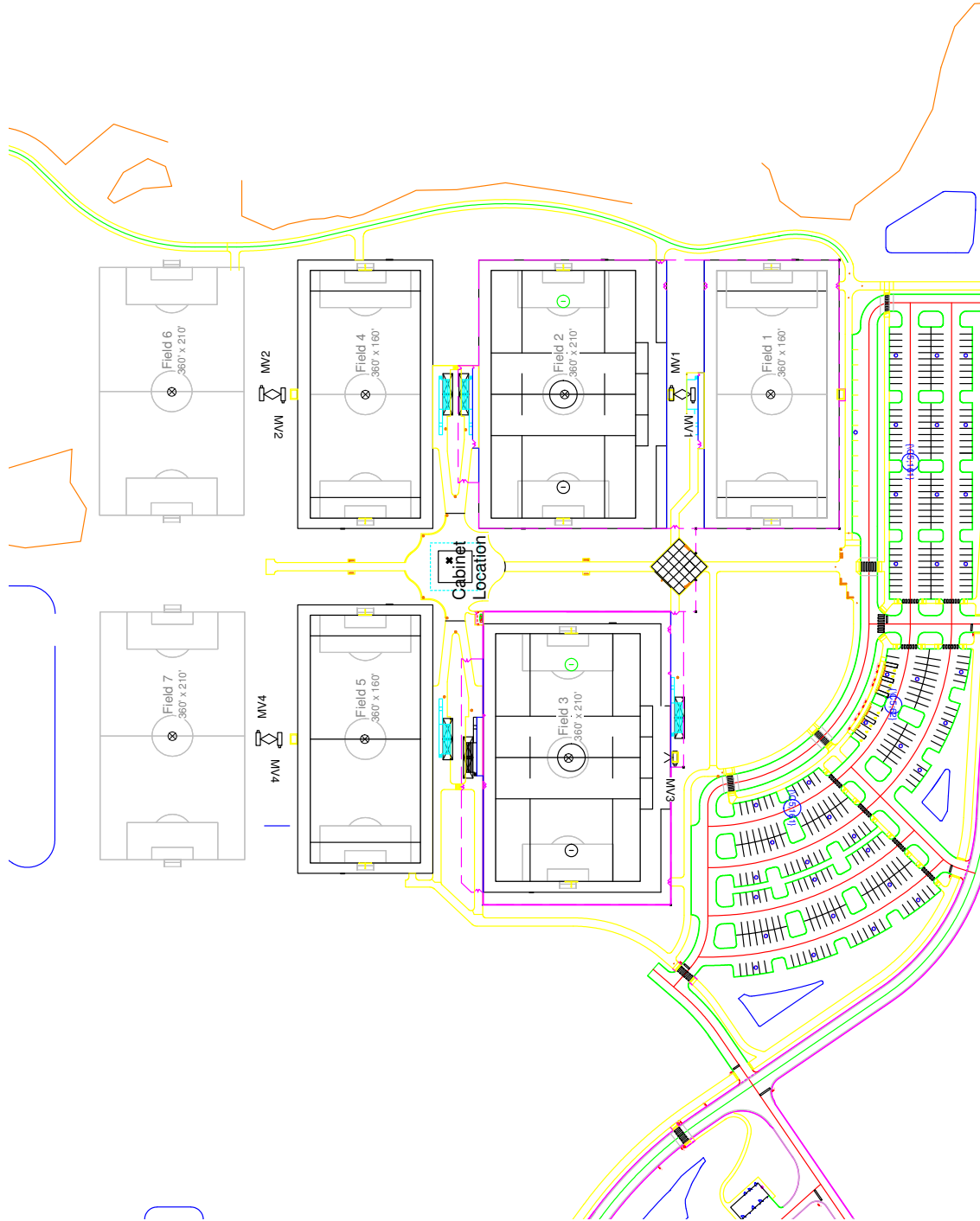

Pole location(s)  $\Phi$  dimensions are relative to 0.0 reference point(s)  $\otimes$

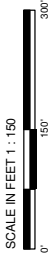

SCALE IN FEET 1 : 150  
ENGINEERED DESIGN By: Connor Ramstead - File #Z00615C - 09-Aug-21



**We Make It Happen.**

Not to be reproduced in whole or part without the written consent of Musco Sports Lighting, LLC. ©1981, 2021 Musco Sports Lighting, LLC.



*Southeast Municipal Complex  
Prebid Meeting Minutes  
Monday, August 19, 2024, 2:00 p.m.  
Location: City Hall - Boardroom*

**Attendance:**

**Introductions:**

- Shahad Abdulrahman: City of Franklin Engineering Department (City Project Manager)
  - 615-791-3218 (Main Office) ext. 6708
  - [Shahad.Abdulrahman@franklintn.gov](mailto:Shahad.Abdulrahman@franklintn.gov)

See attached attendance Sheets for the rest of the attendees.

**General Agenda Items:**

1. Introductions & Roles
2. Summary of contract requirements:
  - a. Substantial Completion timeline
  - b. Discuss a NTP Date.
3. Review of Permits:
  - A. Tennessee Valley Authority (TVA) Approval for Development Between Structures 808/767 and 821/754 – Tract CNTGC-18 – City of Franklin – Williamson County, Tennessee. – **Permit Approved.**
  - B. Department of the Army – 2021 Nation Wide Permit. **Permit Approved.**
  - C. Tennessee Department of Environment and Conservation Stormwater Discharges Associated With Construction Activities (CGP) Tracking No. TNR245481. **Permit Approved.**
  - D. Tennessee Department of Environment and Conservation General Permit for Construction of Intake and Outfall Structures (ARAP-NR2104.372). **Permit Approved.**
  - E. Tennessee Department of Environment and Conservation Stormwater Injection Well (UIC Number: WIL 0000228). **Permit Approved.**
  - F. Tennessee Department of Transportation – Approval to Bore Water Main and Casing Pipe under I-65. **Permit Approved.**
  - G. Tennessee Department of Transportation – Approval to Bore Reclaimed Water Main and Casing Pipe under I-65. **Permit Approved.**



*Southeast Municipal Complex  
Prebid Meeting Minutes  
Monday, August 19, 2024, 2:00 p.m.  
Location: City Hall - Boardroom*

- H. Tennessee Department of Environment & Conservation Public Water System Permit – This permit shall be obtained by the City of Franklin.
- I. Tennessee Department of Environment & Conservation Public Sewage Works Permit – This permit shall be obtained by the City of Franklin.
- J. City of Franklin Stormwater/Grading Permit and Utility Permit – To Be Finalized by the General Contractor. Contractor will be reimbursed exact fees associated with any permit applications. Permit Fees should be waived for City Projects.
- K. City of Franklin Flood Plain Development Permit. **Permit Approved.**
- L. City of Franklin Building Permit – To Be Finalized by the General Contractor. Contractor will be reimbursed exact fees associated with any permit applications. Permit Fees should be waived for City Projects.
- M. City of Franklin Wall/Building Permit – To Be Finalized by the General Contractor. Contractor will be reimbursed exact fees associated with any permit applications. Permit Fees should be waived for City Projects.
4. Submittals:
- a. COF will require submittals and mock-ups as necessary.
5. Utility locates:
- a. Contact Tennessee One Call and GC required to locate private utilities onsite (ex-water mains, services, fire loops, street lighting, etc).

**Specific Discussion Items:**

- Questions will be answered via addendum.
- Discuss bid approval process.
- Sequencing of the work for SEMC.
- Site access.
- Discuss off contract items.

**Open Discussion:**

- Discussed undercutting and quantities provided on the bid form for additional undercutting. City staff confirmed that the contractor bid the quantities on the form.
- Mass blasting is permitted per section 3.3 section B. Rock Excavation.
- It is the Gc's responsibility to survey the athletic fields.
- Playground pavilion will be owner purchased, GC installed.



*Southeast Municipal Complex  
Prebid Meeting Minutes  
Monday, August 19, 2024, 2:00 p.m.  
Location: City Hall - Boardroom*

- Time line and sequencing was discussed for the project. COF will provide clarification on job duration of construction in Addendum 1.
- Soil for natural turf fields will be imported if soil on site does not meet qualifications.
- Grading will be to 1/10 of a foot for the synthetic fields
- C OF shared that the GC's interested in turning in a bid **MUST** purchase bid books.
- All questions will be answered via Addendum that will be posted on the city's website.
- Please direct all questions to Shahad Abdulrahman.
- Subs are not required to purchase a bid book but will need to contact GC's to coordinate and provide estimates.





HISTORIC  
FRANKLIN  
TENNESSEE



August 19, 2024

Sign-In Sheet

Tyler Coley	BrightView	700.338.8402	tyler.coley@brightview.com
Colton Motz	Bowen	317-793-0319	cmotz@bowenengineering.com
Steve Gaddine	"	615-210-7187	Steve.Gaddine@BowenSwainsboro.com
Sean Griggs	Griggs Audio-Visual	615-674-1916	Sgriggs@griggsaudio.com
Nick Solim	Baker, Constructors	615 854-0767	nsolim@baker.com
Robert Hutchinson	SessionsPaving Company	615-856-0600	rhutchinson@sessionspaving.com
Eric Krutwick	W.E. O'Neil const	615-913-0691	ekrutwick@weoneil.com
Steven Cull	W.E. O'Neil Const	615 969 6587	Scull@weoneil.com
Michael Pigg	Barge Design	615-252-4251	michael.pigg@bargedesign.com
Fornie Lane			

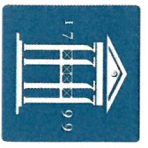

HISTORIC  
FRANKLIN  
TENNESSEE

**SEMC**

August 19, 2024

Sign-In Sheet

TJ, Pamley	Professional Drafts USCONSISTERS (PAPER)	615-807-2100	tj.pamley@pavs.com
Doc Hawn II	Sain Const Co	931-712-4415	aharrell@sainconstruction.com
Ryan Slaughter	Smith Constructors	615-579-8554	rslaughter@smith-constructors.com
KEID WARD	SMITH CONSTRUCTORS	615-533-7712 615-533-3360 615-251-1311	ward@smith-constructors.com
Zack Carter	Landscape Services Inc.	615-714-0828	Zackcarter@LSIpros.net / Paul Slaughter@LSIpros.net
Allen Buchanan	Doodle Construction	678-978-1809	ABUCHANAN@DOODLECONSTRUCTION.COM
Brandon Thomas	Reeves Young	615-924-0334	Dthomas@reevesyoung.com
Lee Holland	Reeves Young	615-939-2023	Lholland@reevesyoung.com
Richard Erwin	Jones Brothers Contract	615-794-4554	rerwin@jonesbroscnt.com
Michelle Apple	COI	(615) 613-5256	michelle.holmes@kentucky.gov
John Davis	Division 2 Contractors	615-664-9710	jdavis@DIV-2.com
Brian Nelson	DOSTER CONSTRUCTION	615-927-2615	bnelson@dosterconstruction.com
Joe Wall	Doster Const.	615-840-0401	jwall@dosterconstruction.com
MICHAEL LUHENS	DOSTER CONST	702-218-2752	MLUHENS@DOSTERCONSTRUCTION.COM
Adam Milner	DeAngelis Diamond Construction		adam.milner@deangelisdiamond.com
Taylor Kay	Jarrett Companies	615-515-1270	taylor@jarrettsiteandwork.com



August 19, 2024

Sign-In Sheet



NAME	COMPANY	PHONE	EMAIL
Shahad	City of Franklin	615-550-6708	Shahad.abdulrahman@franklinton.gov
Abdulrahman	City of Franklin	615-550-6679	Paul.Holzen@franklinton.gov
Paul Holzen	City of Franklin	615-550-6679	Paul.Holzen@franklinton.gov
Jon Carman	City of Franklin	615-347-9409	Jon.carman@franklinton.gov
Kevin Lindsey	CVT	615-394-2971	KevinL@FranklinTN.gov
MATT FELL	BARGE DESIGN'S	615-252-4332	MATT.FELL@BARGEDESIGN.COM
Paige Cnuse	COF	615-112-1827	paige.cnuse@franklinton.gov
Jon Carman	CO4		jon.carman@franklinton.gov
David Hite	Sain Const	415-478-4212	dhite@sainconstruction.com
Brent Obersteadt	Sain	415-804-5730	bobersteadt@sainconstruction.com
Edwyn Freeman	COF		
DAVID L HODNETT	COF	318-237-8448	david.hodnett@franklinton.gov

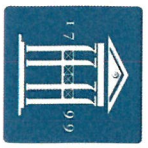

HISTORIC  
FRANKLIN  
TENNESSEE

**SEMC**

August 19, 2024

Sign-In Sheet

Colb DeLand	Clary Construction	615-207-5243	estimating@claryconst.com
Mary Matthews	Corrado	901-604-7634	mccilliams@corrado.com
Grant Mills	Chris Woods Construction	901-386-3192	gmills@chriswoodsconstruction.com
NATE PHELPS	Civil Constructors	615-207-1759	N.PHELPS@CIVILCONSTRUCTORS.COM
MATT ROBINSON	Civil Constructors	615-981-2975	M.ROBINSON@CIVILCONSTRUCTORS.COM
Teri Labella	Amos Energy	615-418-6699	teri.labella@amosenergy.com
Tyler Serbis	Demol Plus	320-232-4330	tyler@demolplusinc.com
FARREL SKELTON	Floyd & Floyd Contractors	910-210-9877	FARREL SKELTON @ Floyd Floyd Contractors, com
Clay Doelsun	Rec Concepts	931-303-0277	Clay@rec-concept.com
Chuck WITBEAD	McMillan Construction Co.	423 486 3298	Chuck@McMillanConstruction.com
TFT Watson	McMillan Construction	615/300/6453	TFT@McMillanConstruction.com
Ryan McInerney	SPERSTUNE SOLUTIONS	615-566-9799	RYAN@SPERSTUNESOLUTIONS.COM
Chris Ream	Nabholz Construction	629-273-0097	Chris.ream@nabholz.com
Howard Hawk	Moody Excavating	615-785-9933	howard.hawk@moody-llc.com
David Bullington	Persef TN, LLC	615-604-1054	David Bullington, persef@gmail.com
Kenneth Garrett	Byzac's Sons Const.	615-719-1141	KGarrett@byzacandsons.com