



HISTORIC
FRANKLIN
TENNESSEE

ITEM #29
BOMA 01/08/13

MEMORANDUM

December 3, 2012

TO: Board of Mayor and Aldermen

FROM: Paul P. Holzen, Director of Engineering
Eric Stuckey, City Administrator
David Parker, City Engineer/CIP Executive

SUBJECT: **Water Availability Request for 1810 Carter's Creek Pike (Map 77, Parcel 29)**

Purpose

The purpose of this memo is to forward to the Board of Mayor and Aldermen (BOMA) a request for water availability for 1810 Carter's Creek Pike.

Background

A request for water availability for 1810 Carter's Creek Pike, also known as Map 77, Parcel 29, was submitted on November 29, 2012. The request is for 1 single family unit equivalent (SFUE) through a ¾" domestic water meter. The property is adjacent to but not within the City Limits of Franklin. It is within the Urban Growth Boundary as well as the City of Franklin Water Service District. There is an existing 8" water line along Old Carter's Creek Pike that would serve this property.

Financial Impact

None.

Recommendation

Staff recommends that water availability for this parcel be granted in the amount of 1 SFUE.



HISTORIC
FRANKLIN
TENNESSEE

Request for Water and/or Sewer Availability & Associated Costs

Please fill in the following information & return this form with the site plan per directions below. Incomplete forms will result in the request being returned until all of the information is included. Refer to the attached memo for fees and additional information.

Type of Availability Requested:	<input checked="" type="checkbox"/> Water Only <input type="checkbox"/> Sewer Only <input type="checkbox"/> Water & Sewer
Project Name	Auto Clinic of Franklin
Subdivision, Section, Lot	1810 Carters Creek Pk.
Map & Parcel #	map 77 parcel 29
Property Address	1810 Carters Creek Pike
Existing Zoning	Sub urban
City Project # (If Applicable)	
Anticipated sewage flows in Single Family Unit Equivalents (SFUEs). 1 SFUE = 350 GPD.	1 SFUE
Anticipated Water Meter Size for the intended use, determined by the developer's engineer (see chart).	3/4
Applicant's Name & Company	Jeremy Nichols Auto Clinic of Franklin
Applicant's Address	164 Old Carters Creek Pk. Franklin TN 37064
Applicant's Email	auto clinic of franklin@gmail.com
Applicant's Phone #	615-202-3712

* **MUST** submit a preliminary plan with site map, including existing water and sewer lines near the site.

Apply to:

Paul Holzen, P.E. –Engineering Interim Director
109 3rd Ave South
P.O. Box 305
Franklin, TN 37065

Date Submitted: 11-29-12





N.T.S.

**AUTO CLINIC OF FRANKLIN
1810 CARTER'S CREEK PIKE
MAP 77 PARCEL 29.00
EXHIBIT FOR WATER AVAILABILITY**

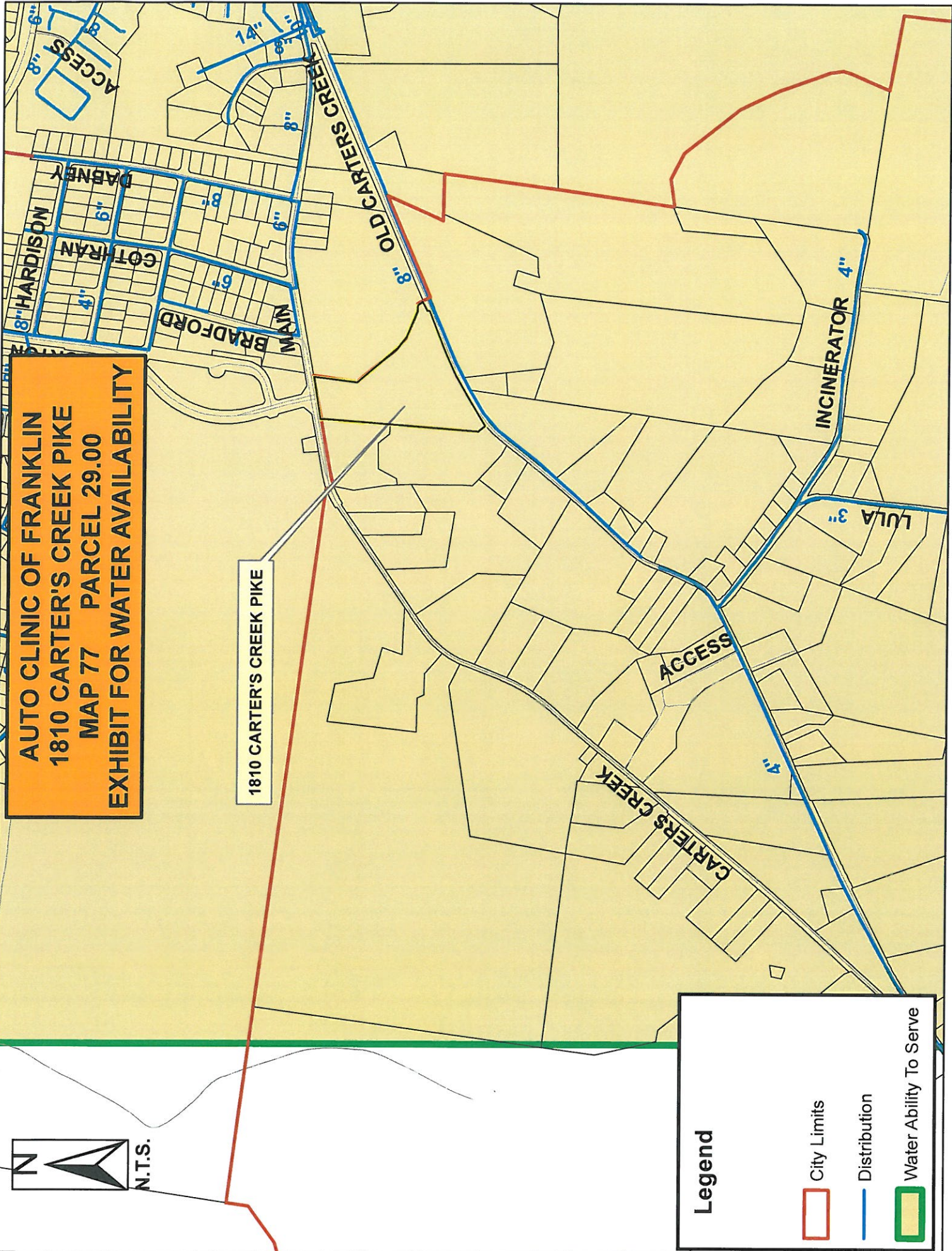
1810 CARTER'S CREEK PIKE



Legend

-  City Limits
-  Distribution
-  Water Ability To Serve